

DENSO KOBELCO SARD RCF BODY SHELL

Official Licensed Product

NO.48767

killerbody™

1/10 RC PLANNING INSTRUCTION SHEET

This body can be used with 1/10 electric touring car chassis (Long Wheelbase: 257mm, Width: 195mm)

Before beginning assembly, please read these instructions thoroughly!

● Symbols used throughout the instruction manual, comprise:



Cut off shaded portion.



5mm
Drill holes with
the specified diameter.



Pay close attention here!



Must be purchased
separately.



Assemble left and right sides
the same way.

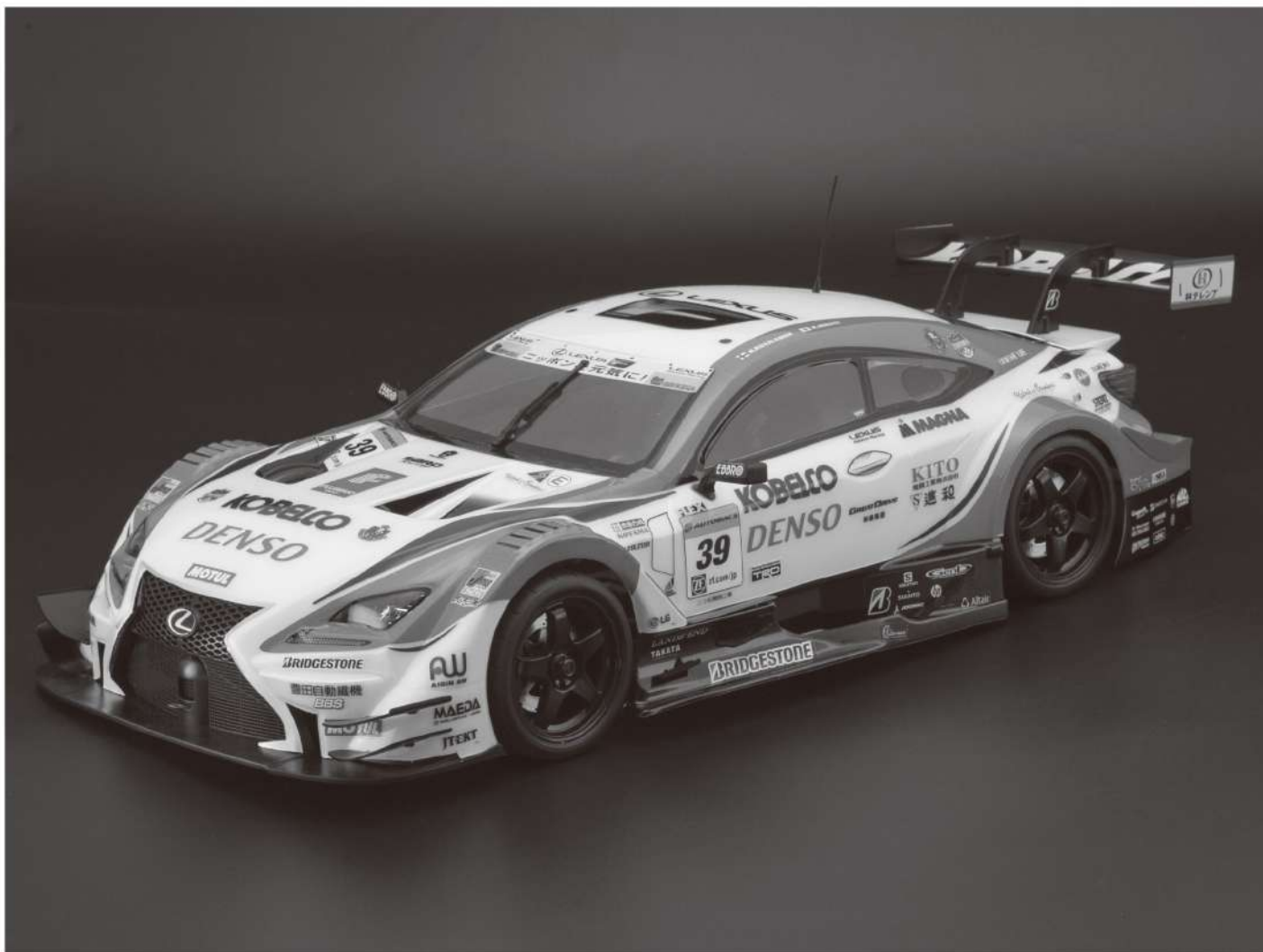

● Before Assembly

Decoration Body

- ▶ In the case of a decoration body, please assemble it according to the contents showed.

When making the window transparent

- ▶ If you want to make the window transparent with a non decoration body, please assemble it according to the contents showed.

Non Decoration Body

- ▶ In the case of non decoration body, please assemble it according to the contents showed.





When loading LED lights

- ▶ If you want to load LED lights with a non decoration body, please assemble it according to the contents showed.

PARTS

- PP part X1
- ABS parts X2
- PC parts X2
- Stainless steel air intake mesh X1
- Trailer ring (red) X1

- Body decal sheet X1
- Window masks X1
- Silver mirror decal X1
- Screw 2.3X5X6mm X2

-  Screw 2.3X6mm X21
-  LED stopper X13
-  Clip X2
-  O-Ring X2

PLASTIC PARTS

A PP part

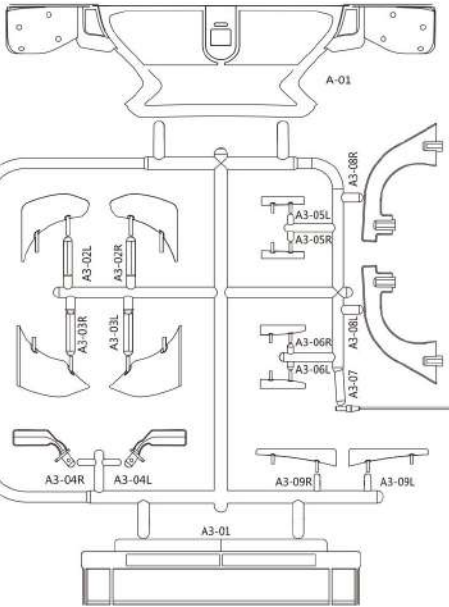

B ABS part-1

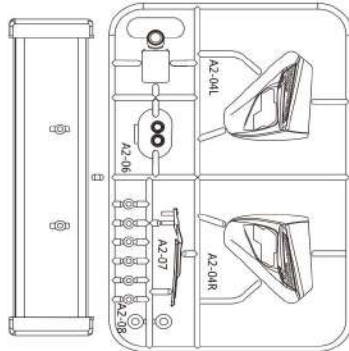

D PC part-1

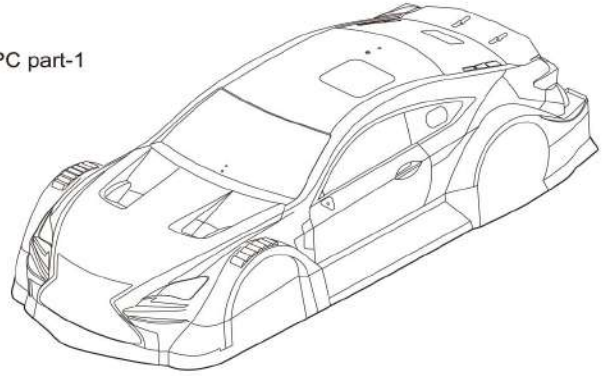

C ABS part-2

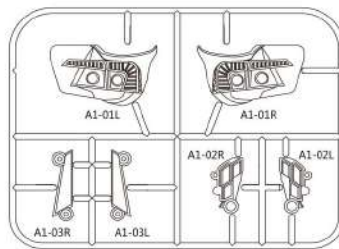

E PC part-2

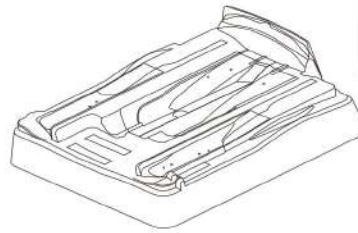

F Stainless steel air intake mesh & Trailer ring (red)

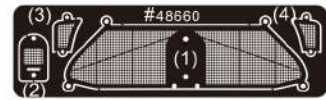

1 Body Shell

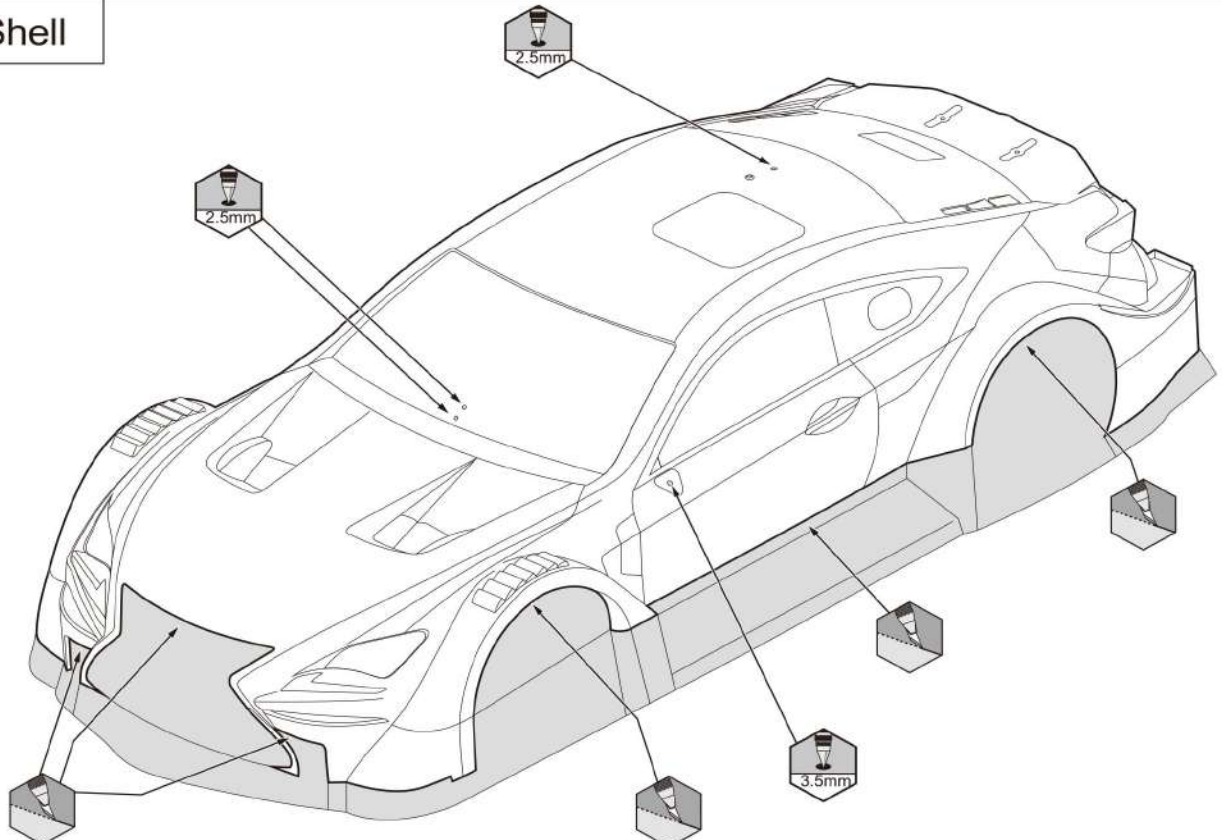

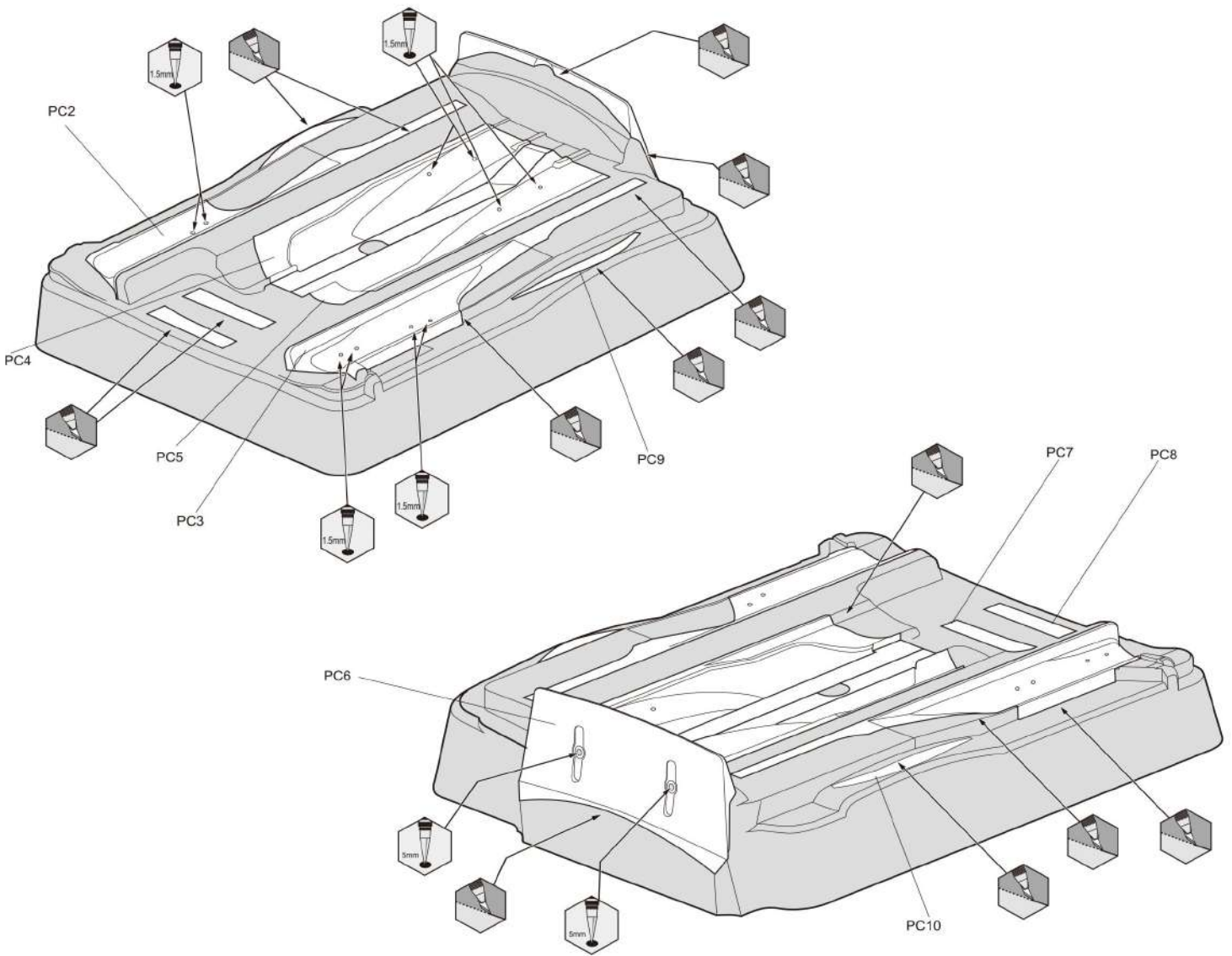
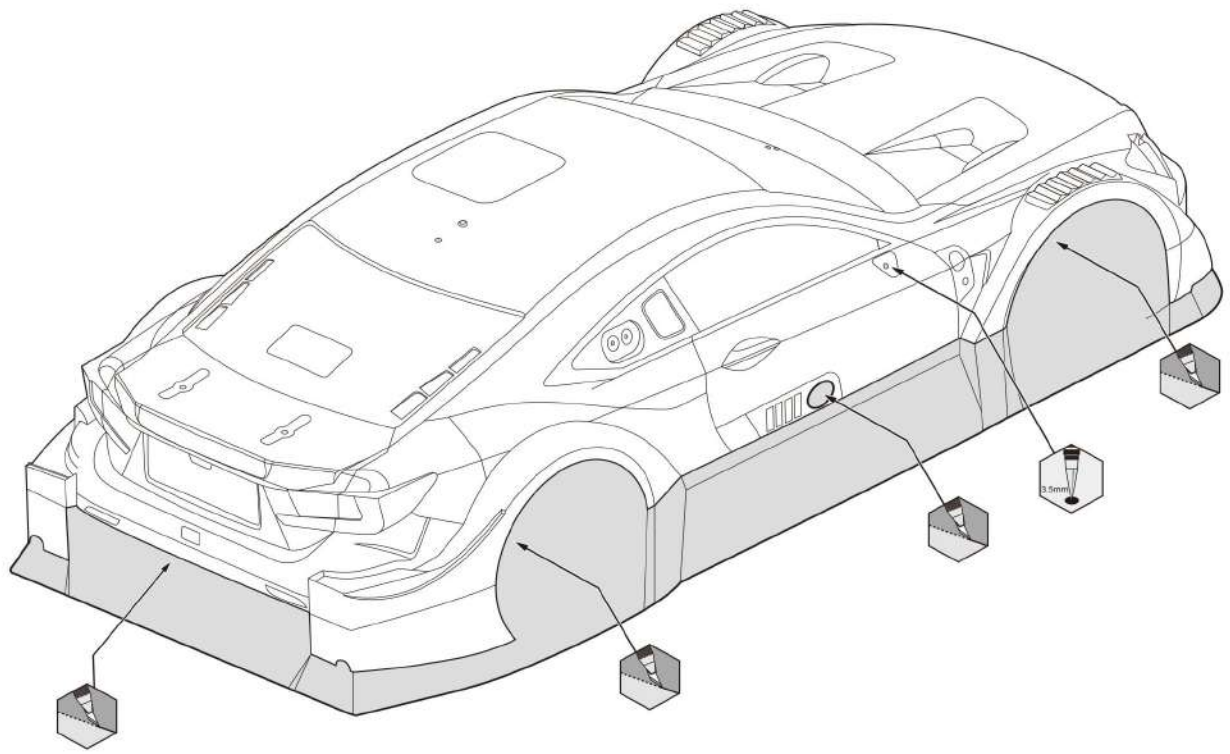

2 Cutting

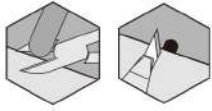

Cut and smooth rough edge.

A B C

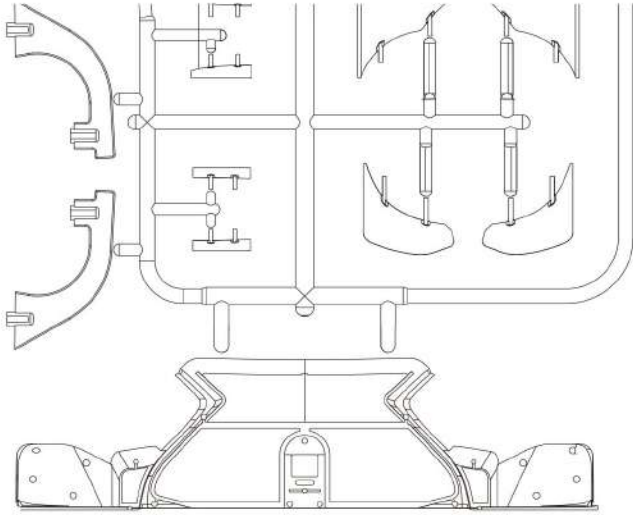

3 Painting

Paint spray color what you prefer on these parts.
It is advised use the recommended spray color as below.

E PC part-2

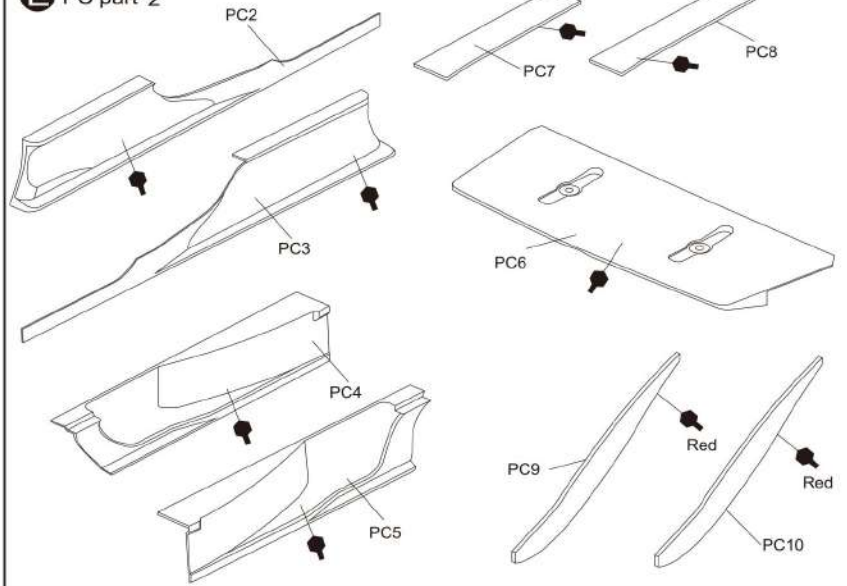

4 Painting

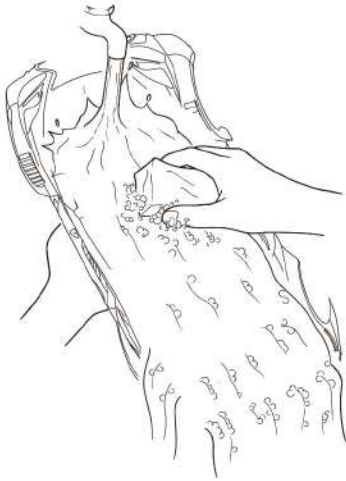

2 Mask the parts from inside.

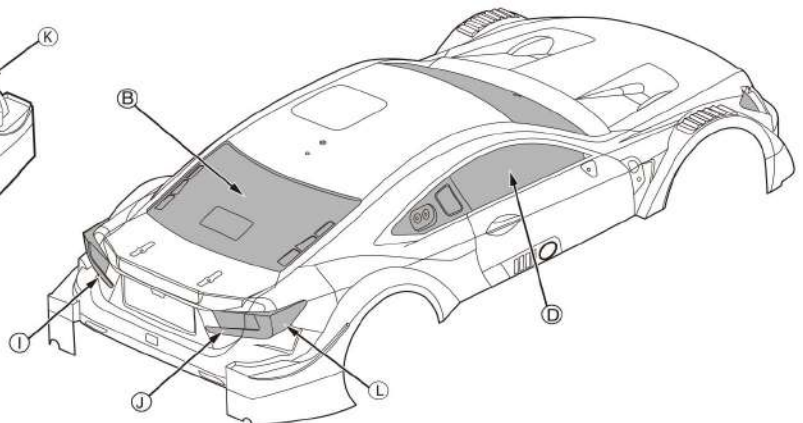
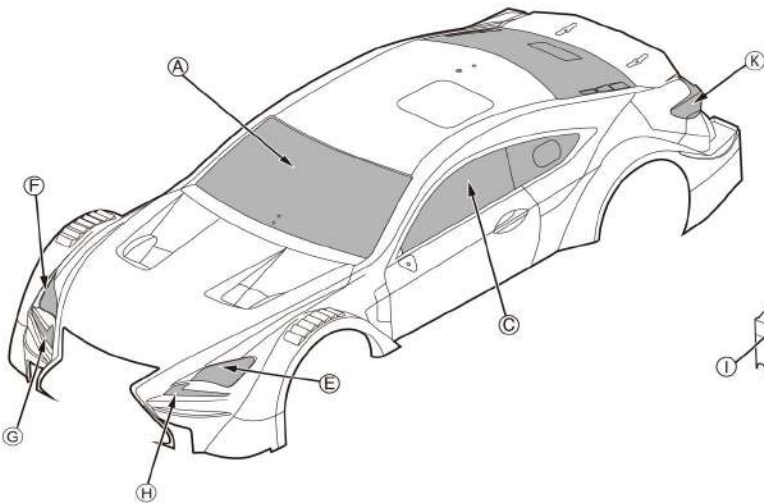
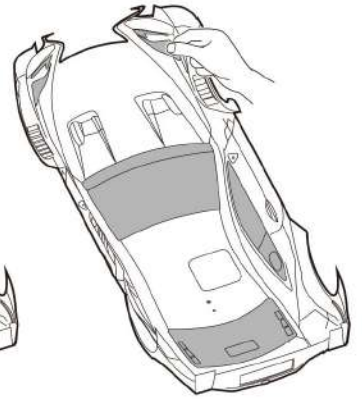
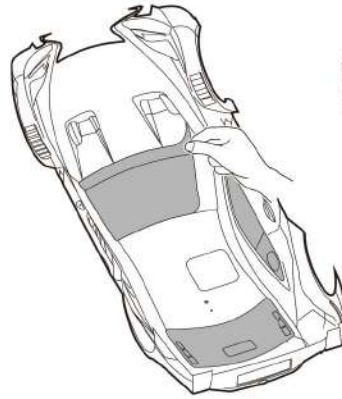
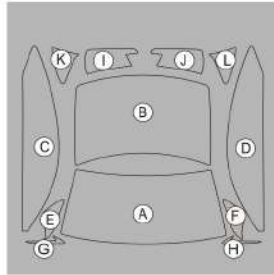

3 Paint spray color from the inside.

D E

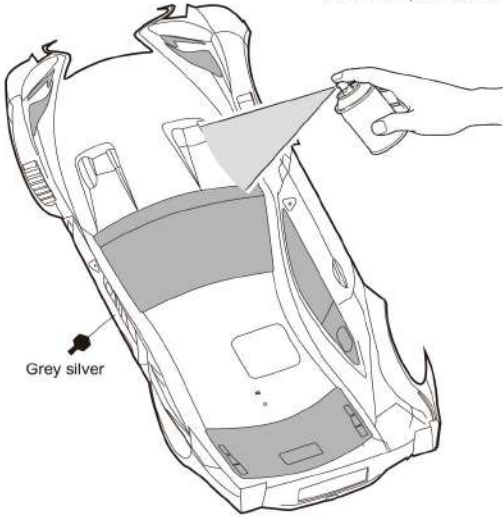

⚠ PC1: Paint blue spray color first, remove the window mask (K), and then paint silver spray color.

4 After painting, remove the protective film from the body shell.

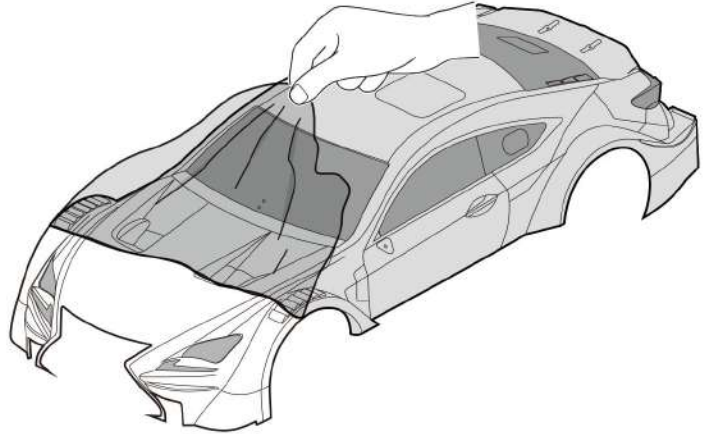

5 Decal

Non Decoration Body

When making the window transparent

When loading LED lights

▶ The decal numbers between brackets are only for the opposite side.

When reproducing the light by decal

▶ Change the decal according to the following contents.



NO.48768 Racing Decal Sheet 2PCS 1/2

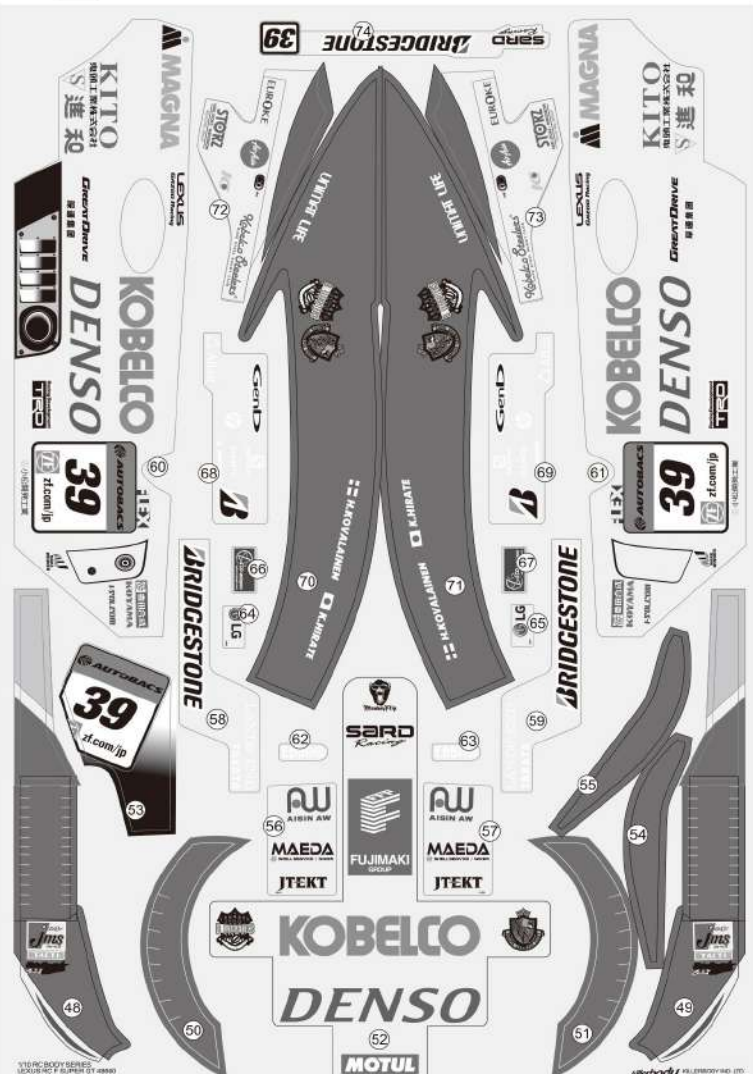
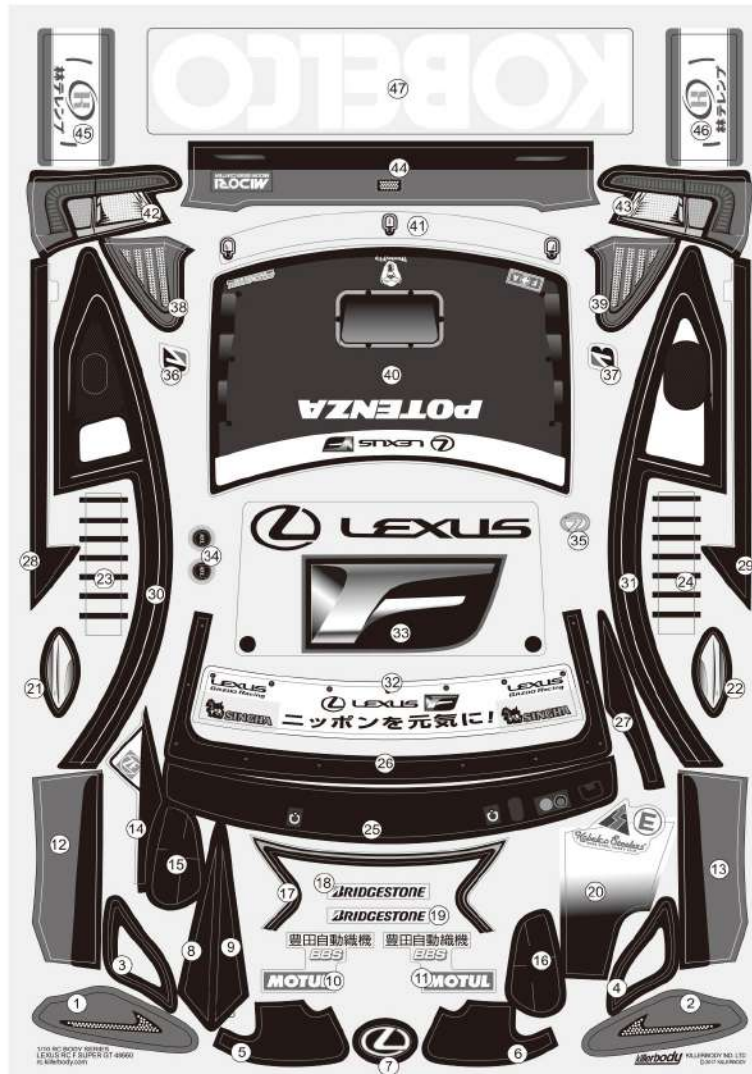

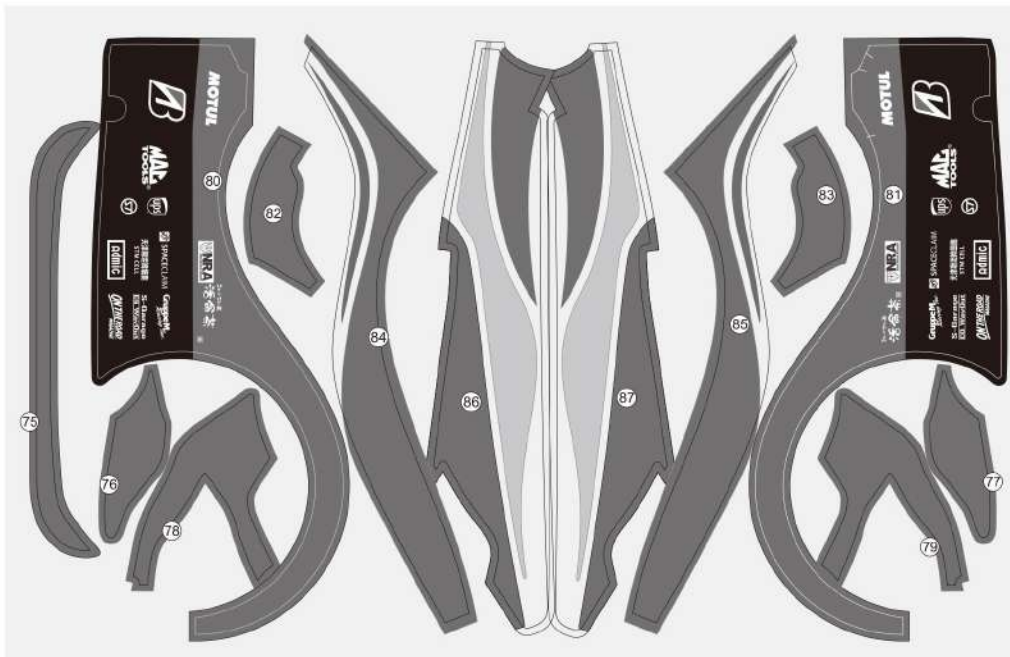

2/2

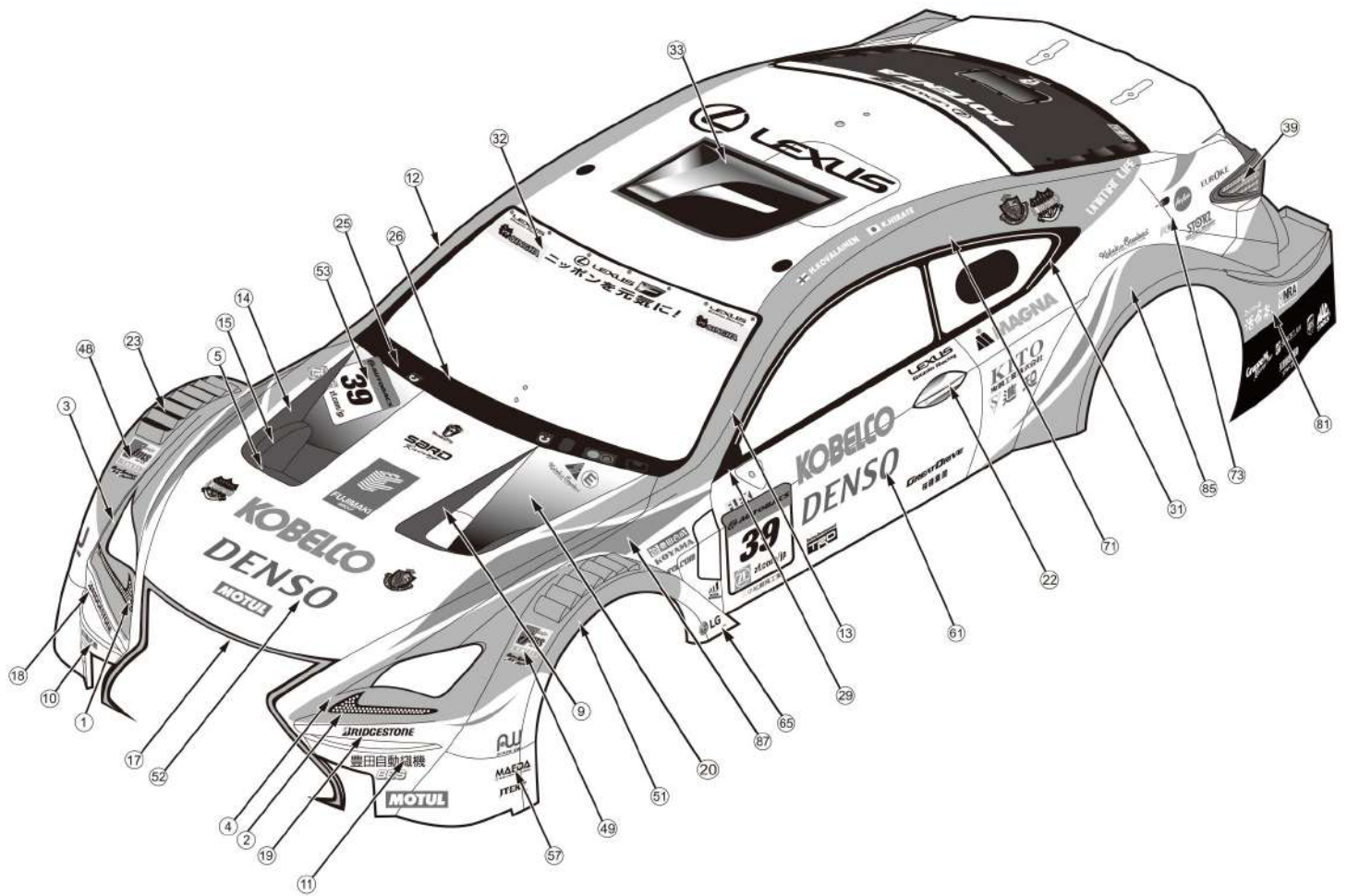

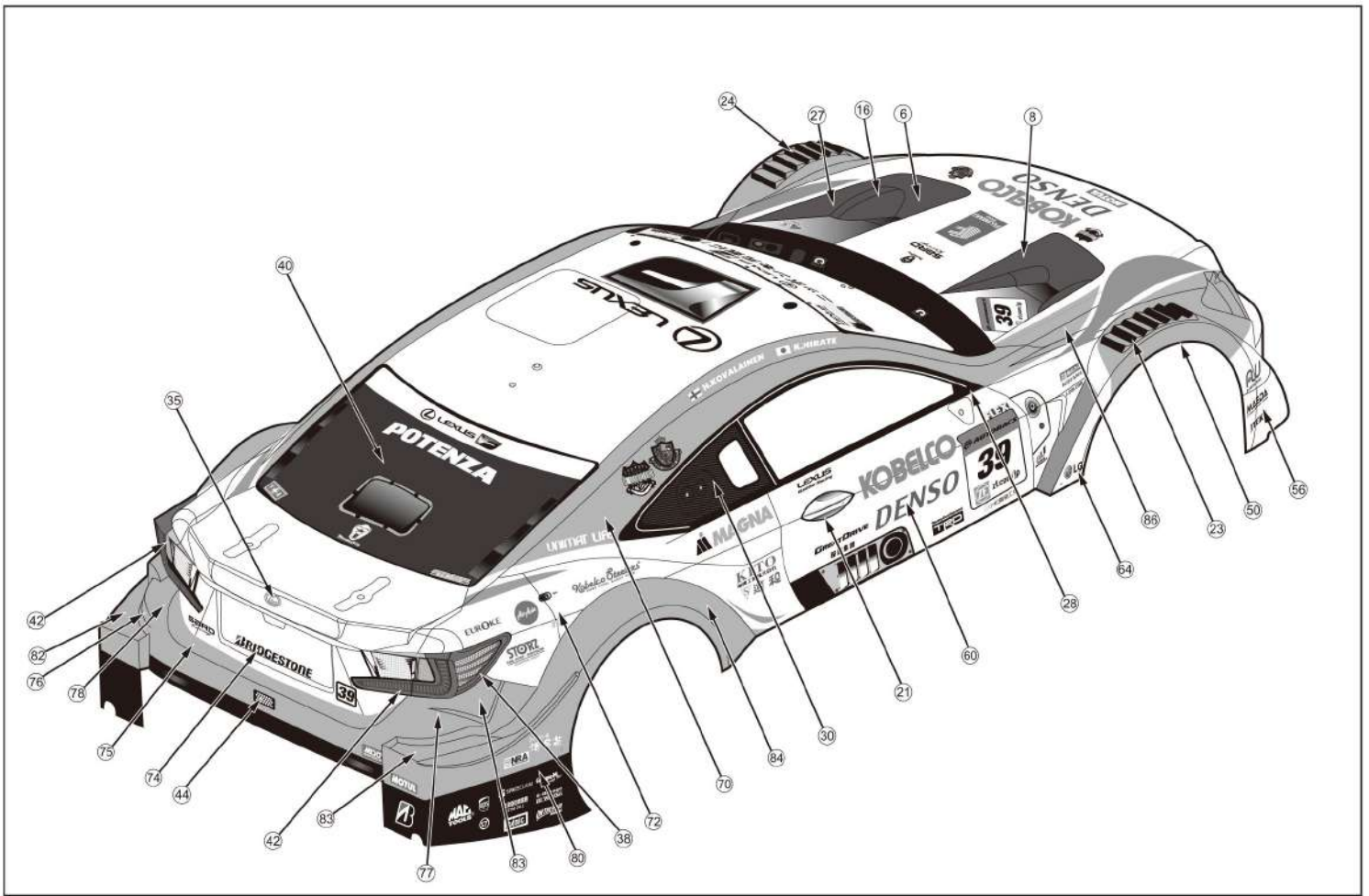

6 Assembling

<Inside>

Trailer ring (red)



Fixing with glue gun.

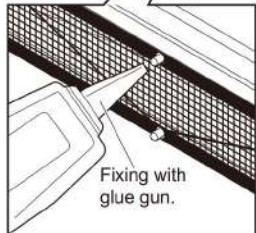
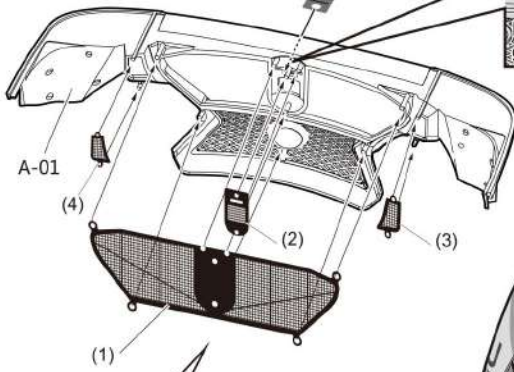

Fixing with glue gun.

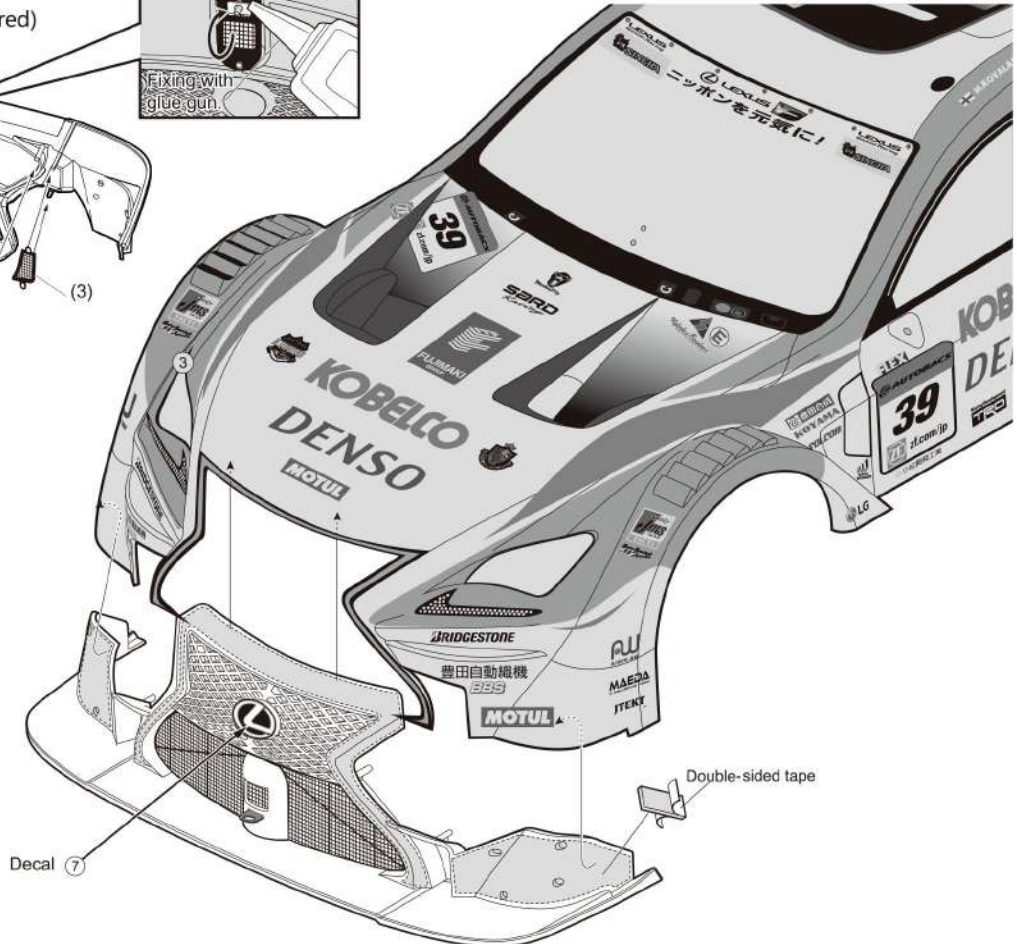

Decal 7

Double-sided tape

7 Assembling

Antenna
X1

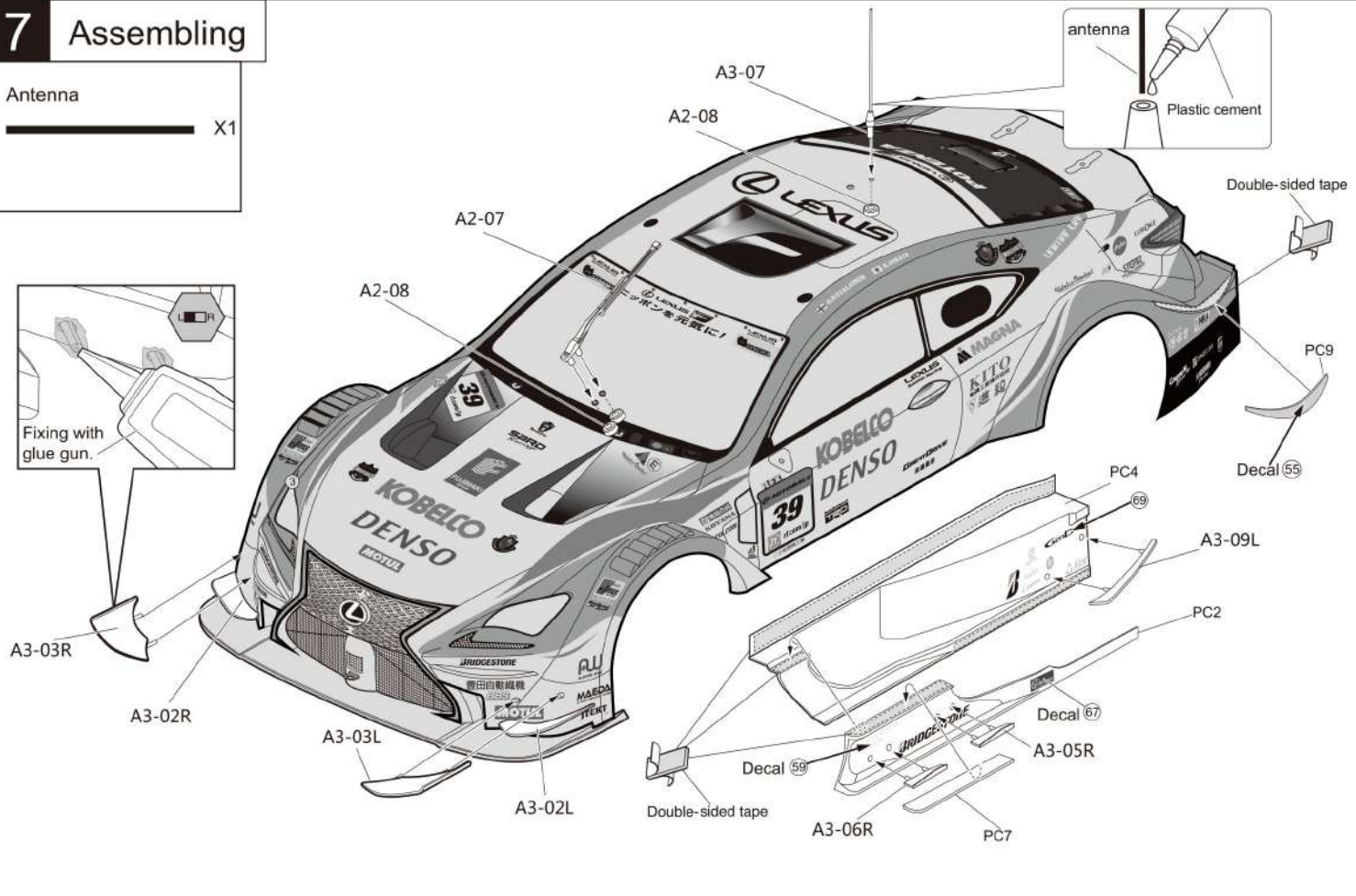
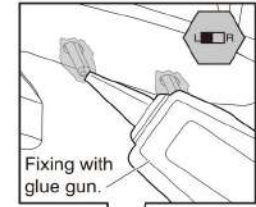

8 Assembling

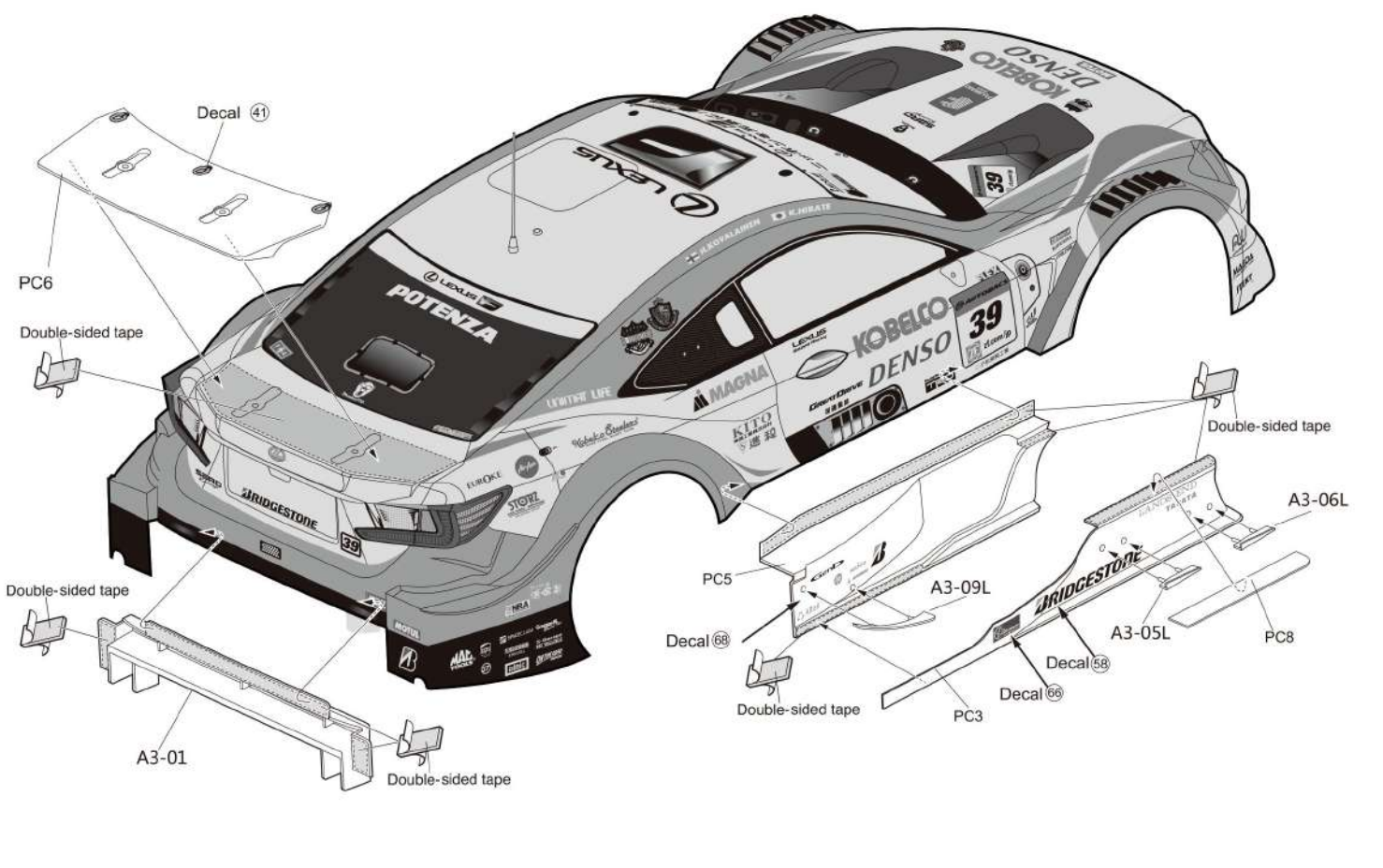

9 Assembling

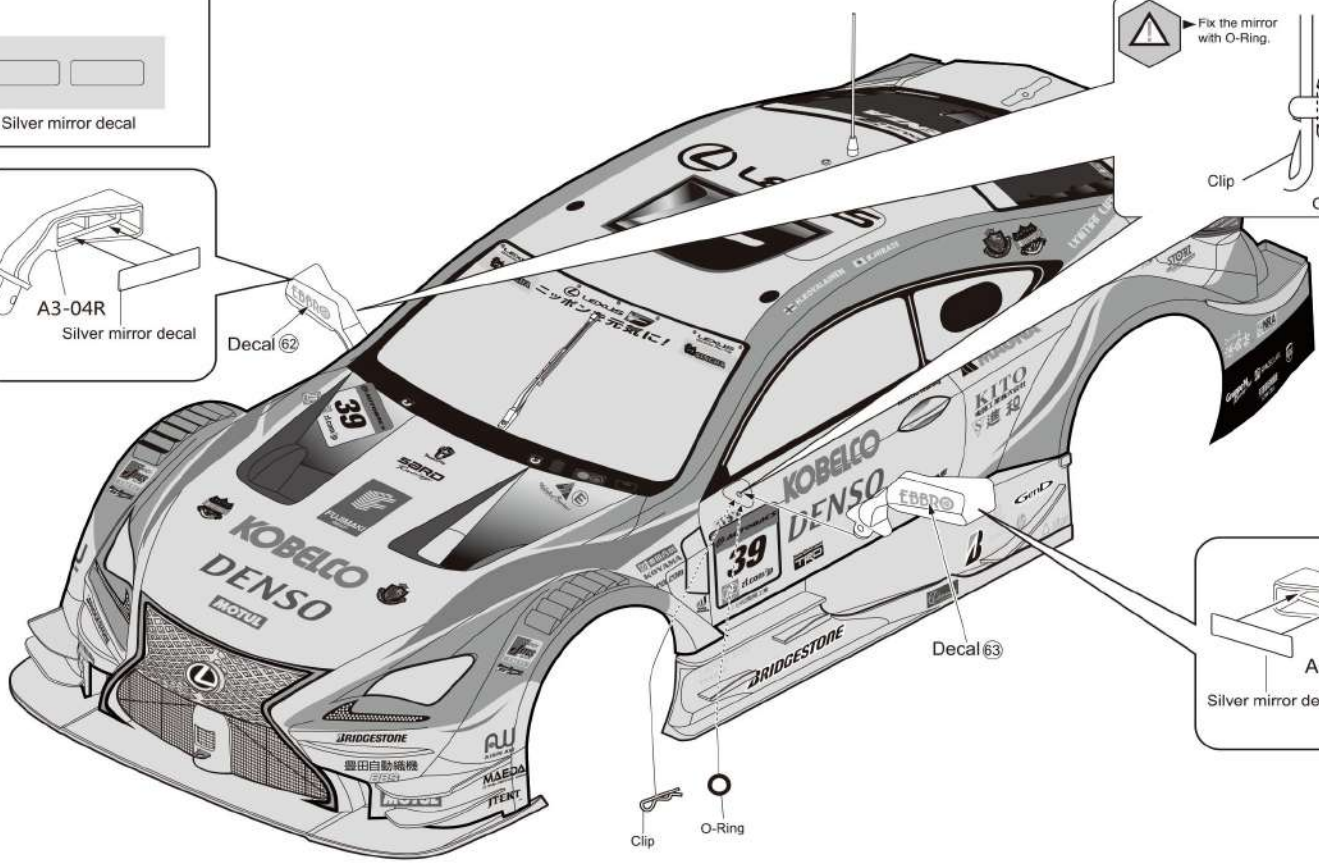
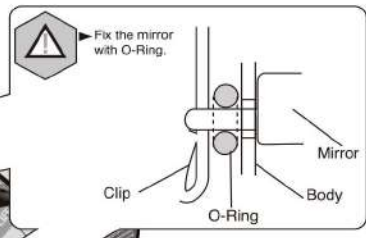
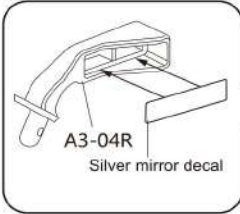

10 Assembling

- Screw 2.3X6mm
-----X2
- Screw 2.3X5X6mm
-----X2

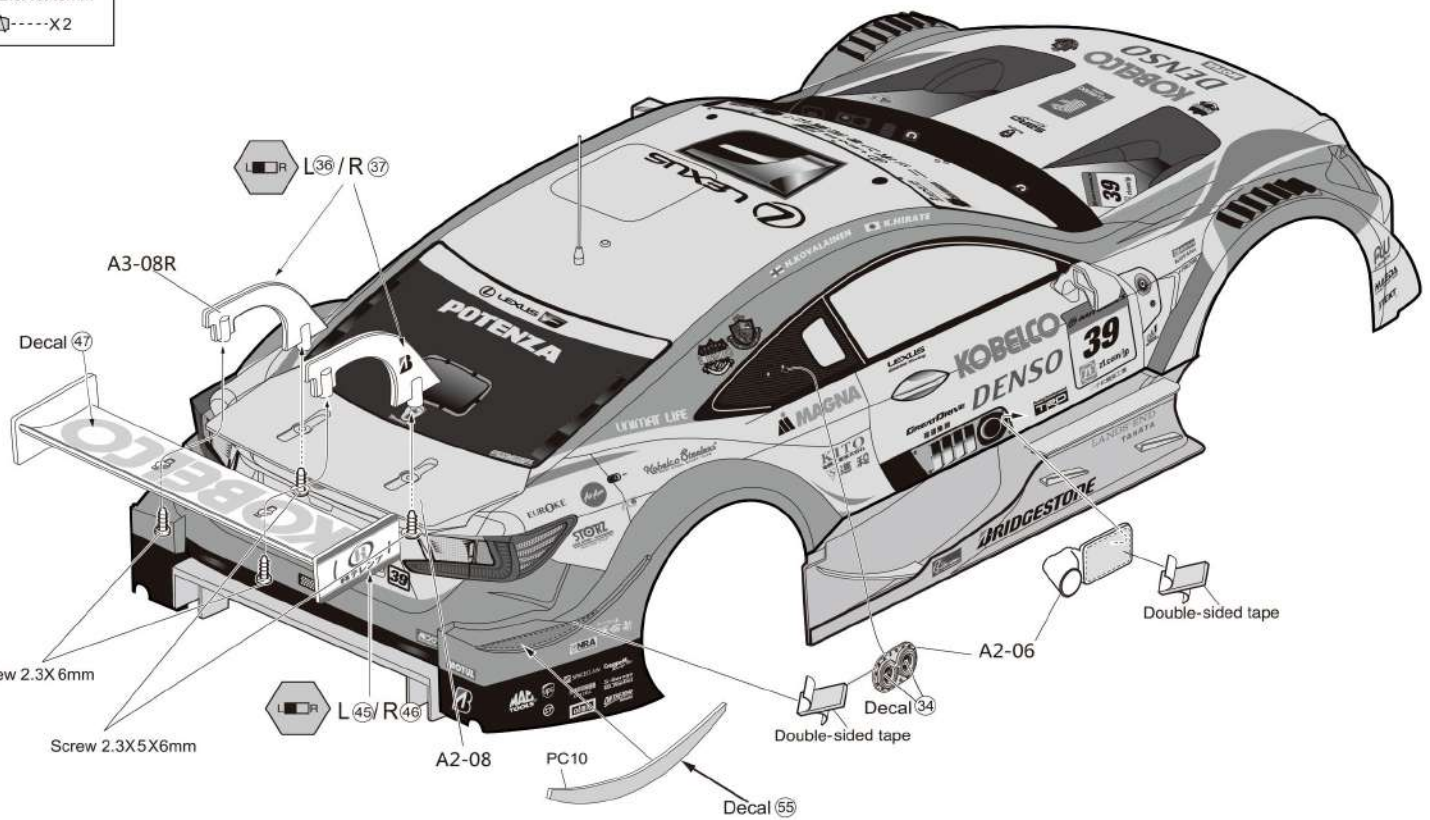

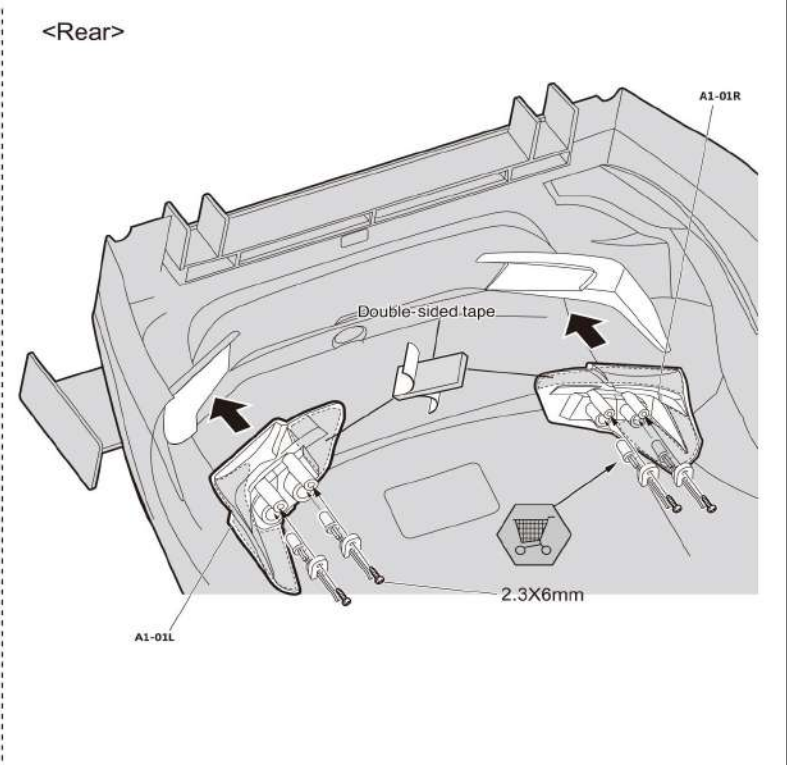
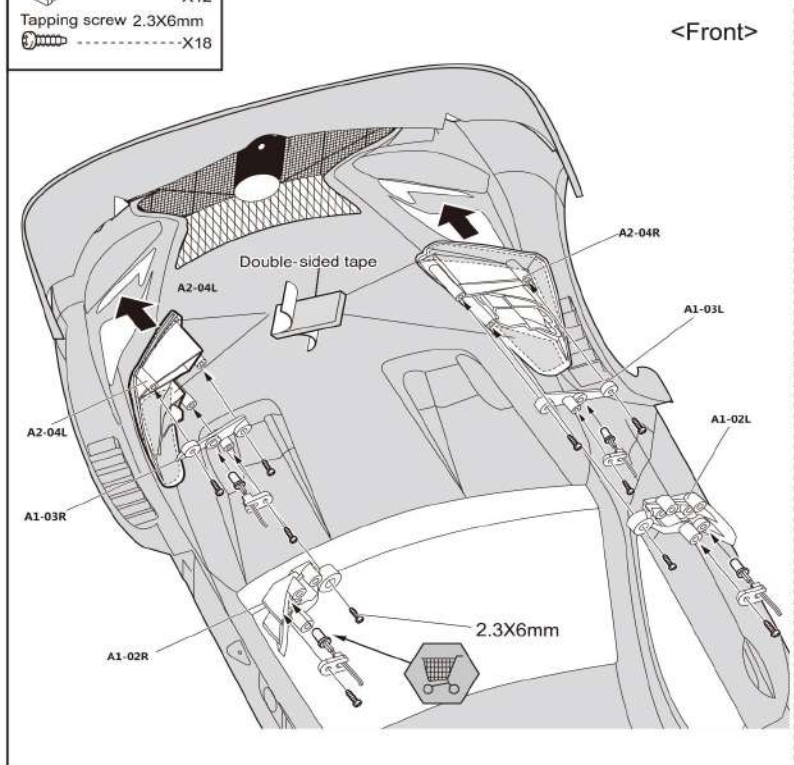

11 Assembling

- LED stopper  -----X12
- Tapping screw 2.3X6mm  -----X18



12 Wires Distribution

- LED 1 (White lights:3mm)  -----X8
- LED 2 (Red lights:5mm)  -----X4
- LED 3 (Blue lights:3mm)  -----X1



NO.48774 LED Unit Set w/Control Box 13 LED(3mm:9 LED; 5 mm:4 LEDS)

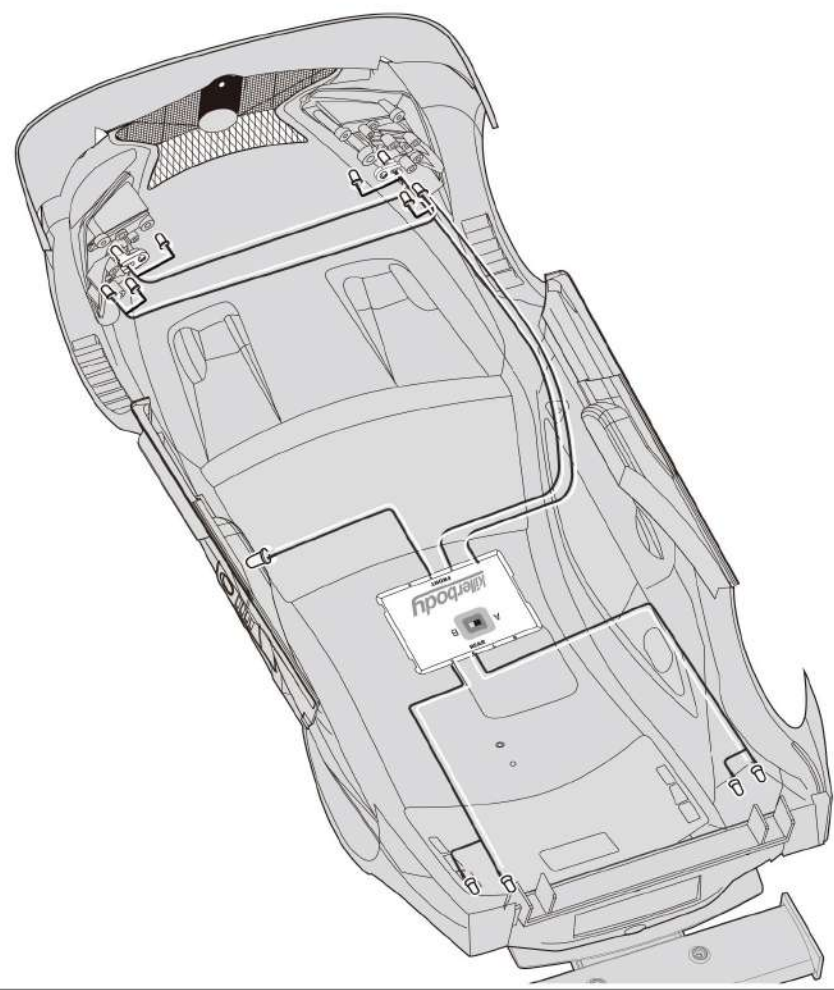

15 Finished



▶ For safety reasons, always fit the body shell when running your car.

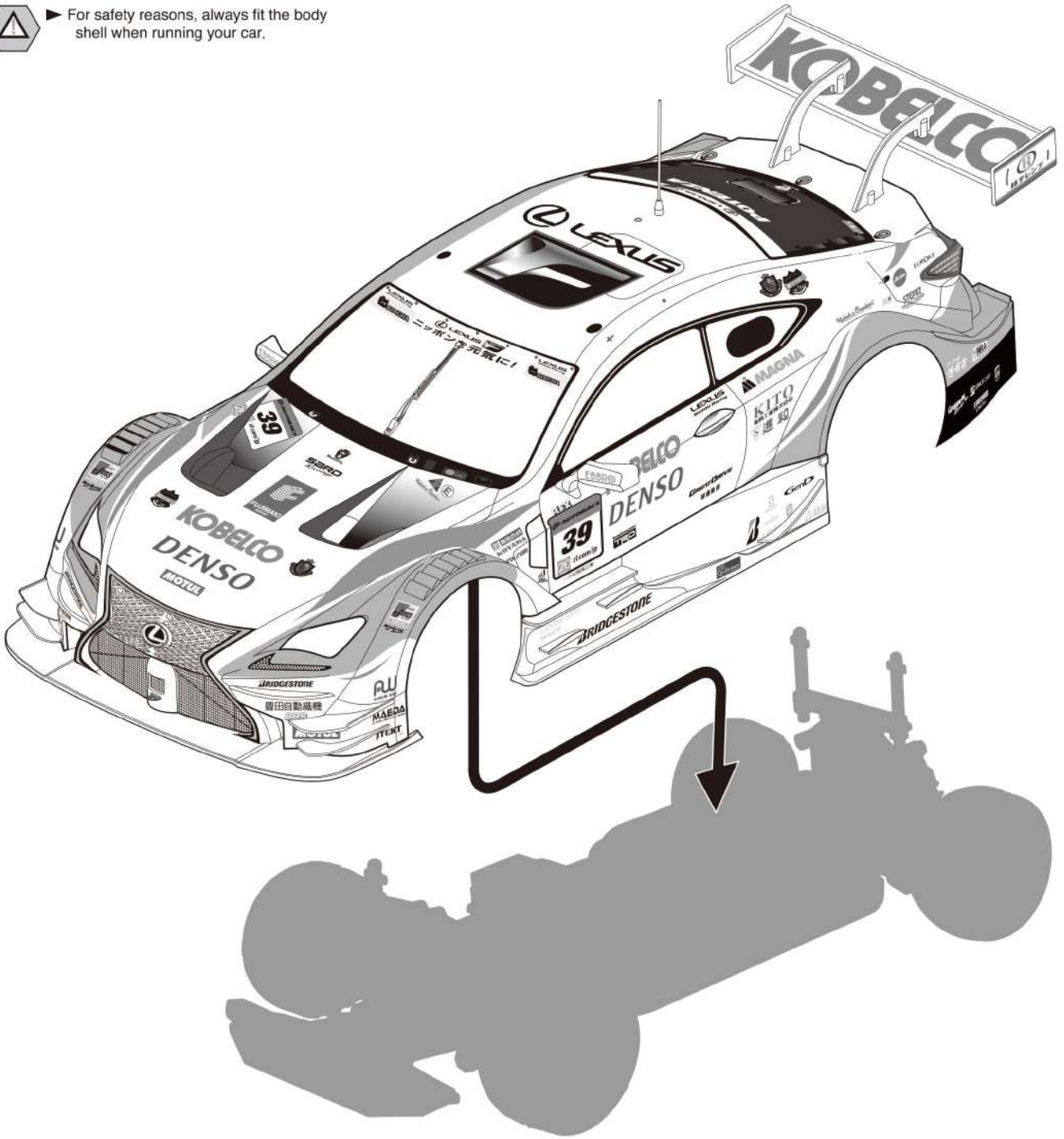

▶ Use the extension body mount (sold separately) if the body mount height is not enough.

