

WARRIOR BODY SHELL

1/10 Scale Crawler

NO.48442

killerbody™

1/10 RC PLANNING INSTRUCTION SHEET

This body can be used with 1/10 scale crawler (Long Wheelbase: 313mm Width: 220mm)

Fit for Axial SCX10 Chassis

Before beginning assembly, please read these instructions thoroughly!

● Symbols used throughout the instruction manual, comprise:



Cut off shaded portion.



5mm
Drill holes with
the specified diameter.



Pay close attention here!



Must be purchased
separately.



Assemble left and right sides
the same way.



● Before Assembly

Decoration Body

- In the case of a decoration body, please assemble it according to the contents showed.

When making the window transparent

- If you want to make the window transparent with a non decoration body, please assemble it according to the contents showed.

Non Decoration Body

- In the case of non decoration body, please assemble it according to the contents showed.

When loading LED lights

- If you want to load LED lights with a non decoration body, please assemble it according to the contents showed.

PARTS

BODY	-----	X1
PLASTIC PARTS	-----	X1
PLASTIC HEADLIGHT	-----	X1
PC PARTS	-----	X4
ELECTROPLATED PC PARTS	-----	X1
NYLON ANTI-ROLL BAR	-----	X1
DECAL SHEET	-----	X1
WINDOW MASKS	-----	X1
SILVER MIRROR DECAL	-----	X1

PARTS BAG

TAPPING SCREW 2.3X6MM	-----	X5
TAPPING SCREW 2.3X4MM	-----	X4
TAPPING SCREW M3X8MM	-----	X12
TAPPING SCREW M1.5MM	-----	X4
TAPPING NUT M1.5MM	-----	X4
PLASTIC WASHER	-----	X6
PLASTIC WASHER	-----	X12

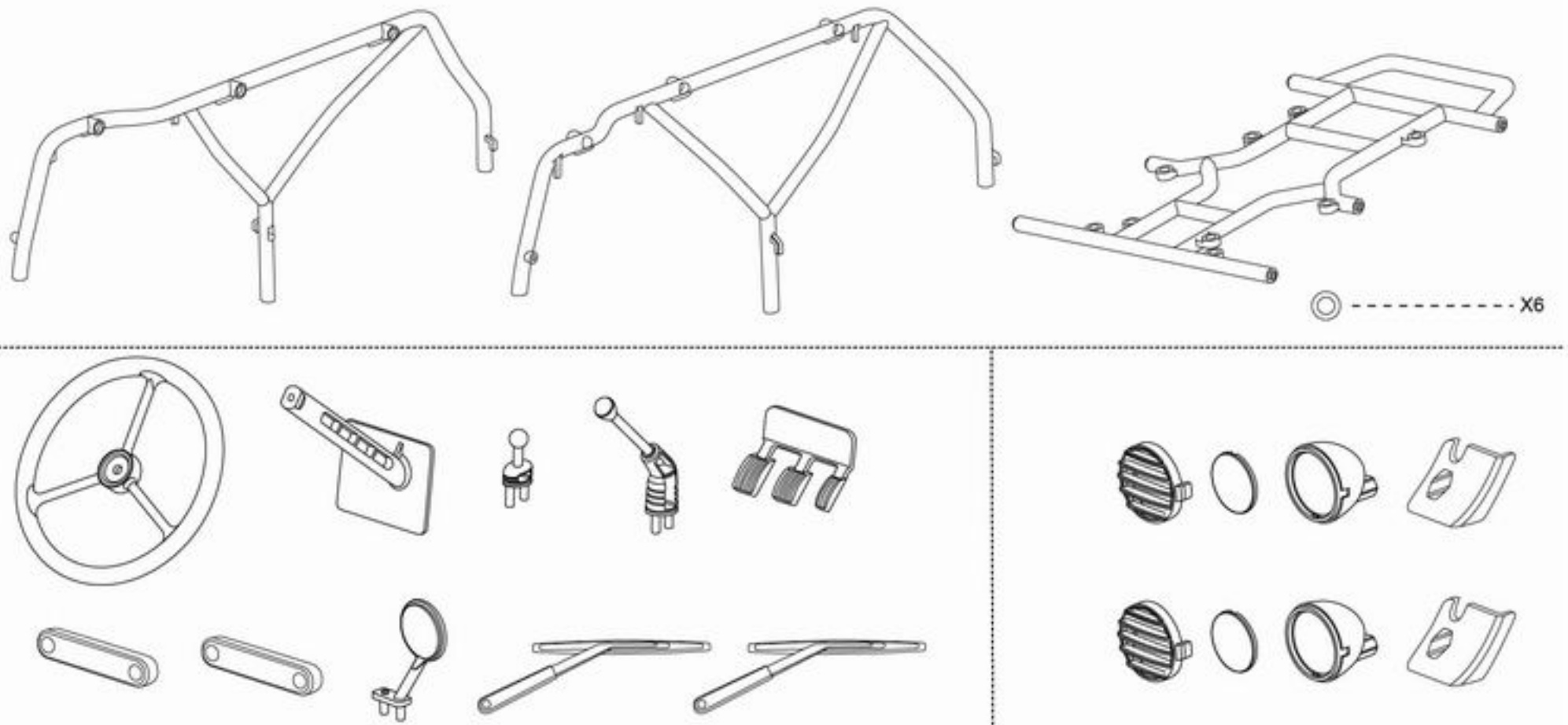

1 Body Shell

Non Decoration Body

When making the window transparent

When loading LED lights

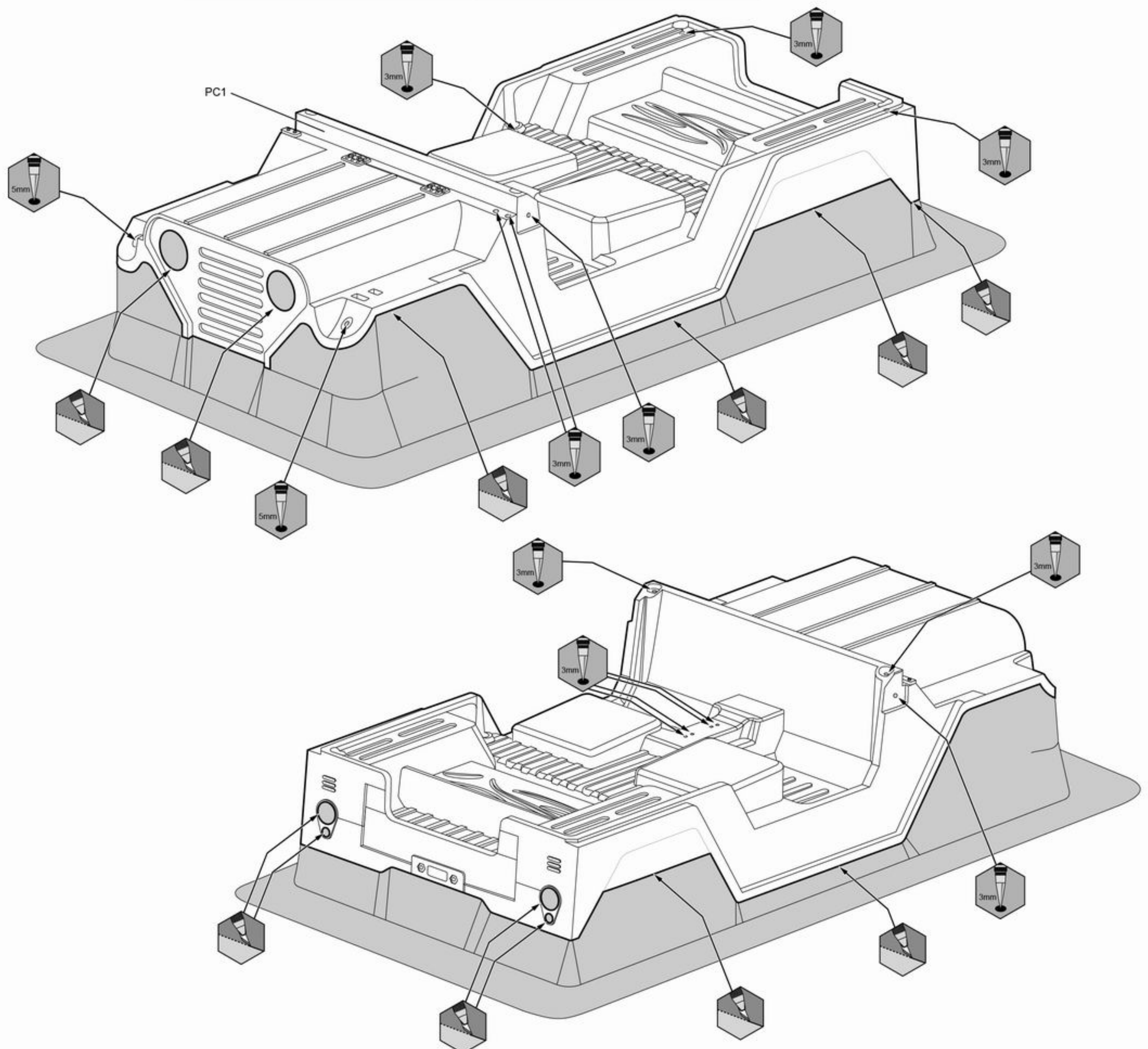

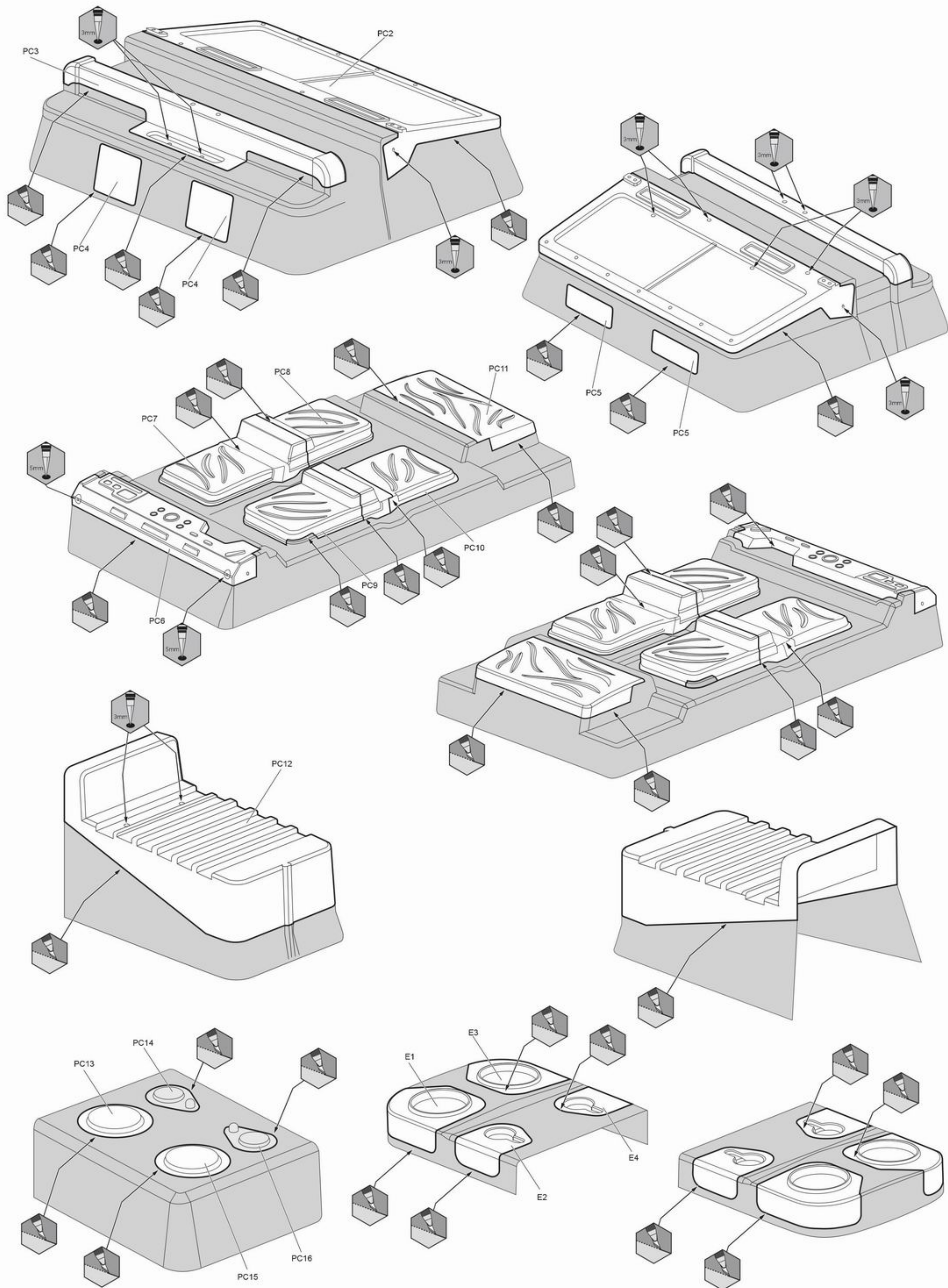

2 Painting

Non Decoration Body
When loading LED lights

PC1 PC2 PC3 PC4 PC5
PC6 PC7 PC8 PC9

① Before painting, use a neutral detergent to remove any oil residues and dirt.

When making the window transparent

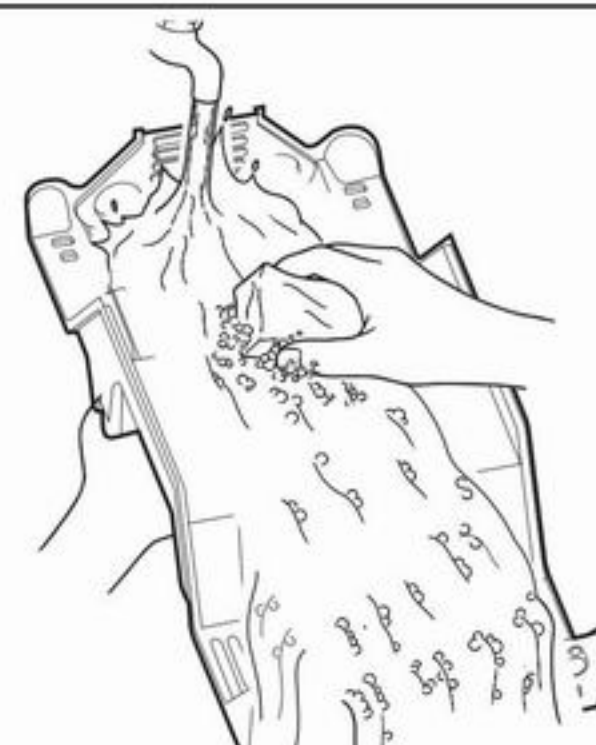

When making the window transparent

② Mask the windows from the inside.

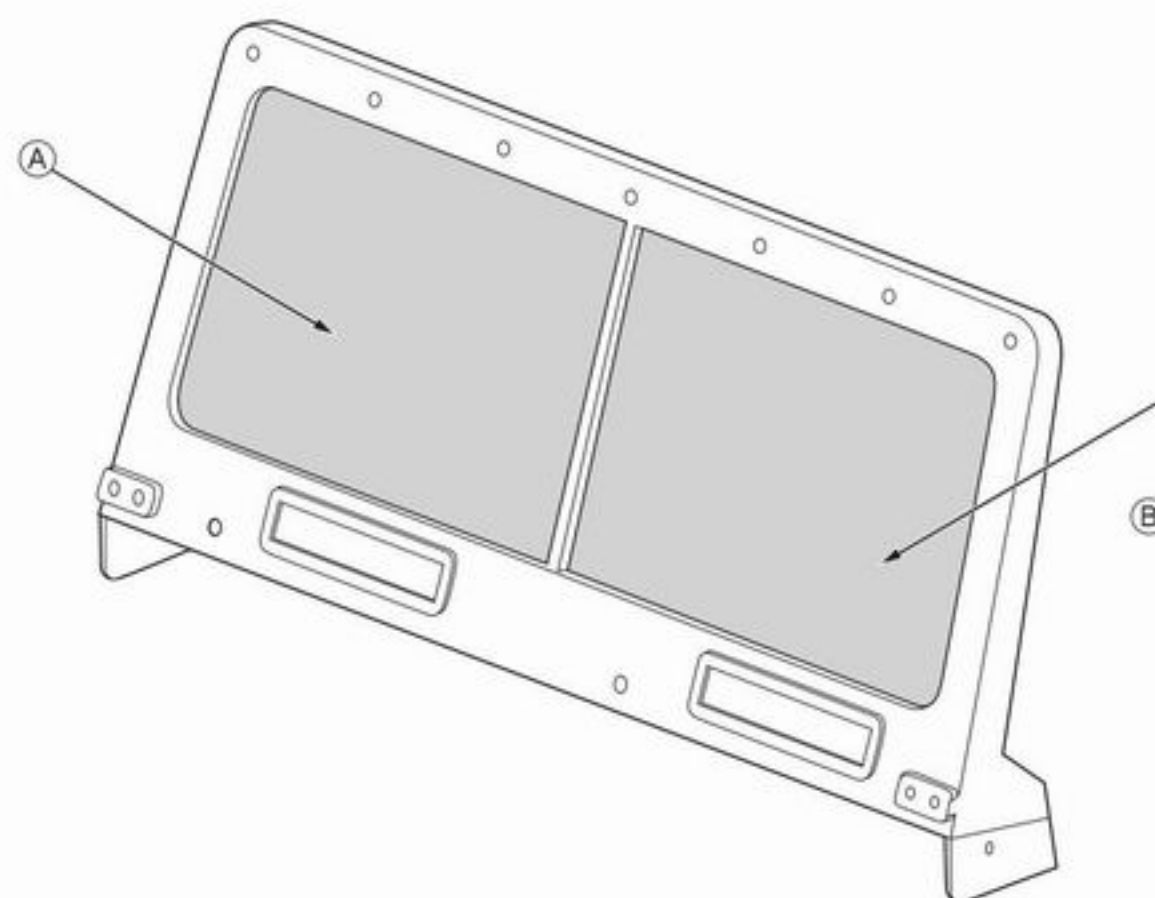
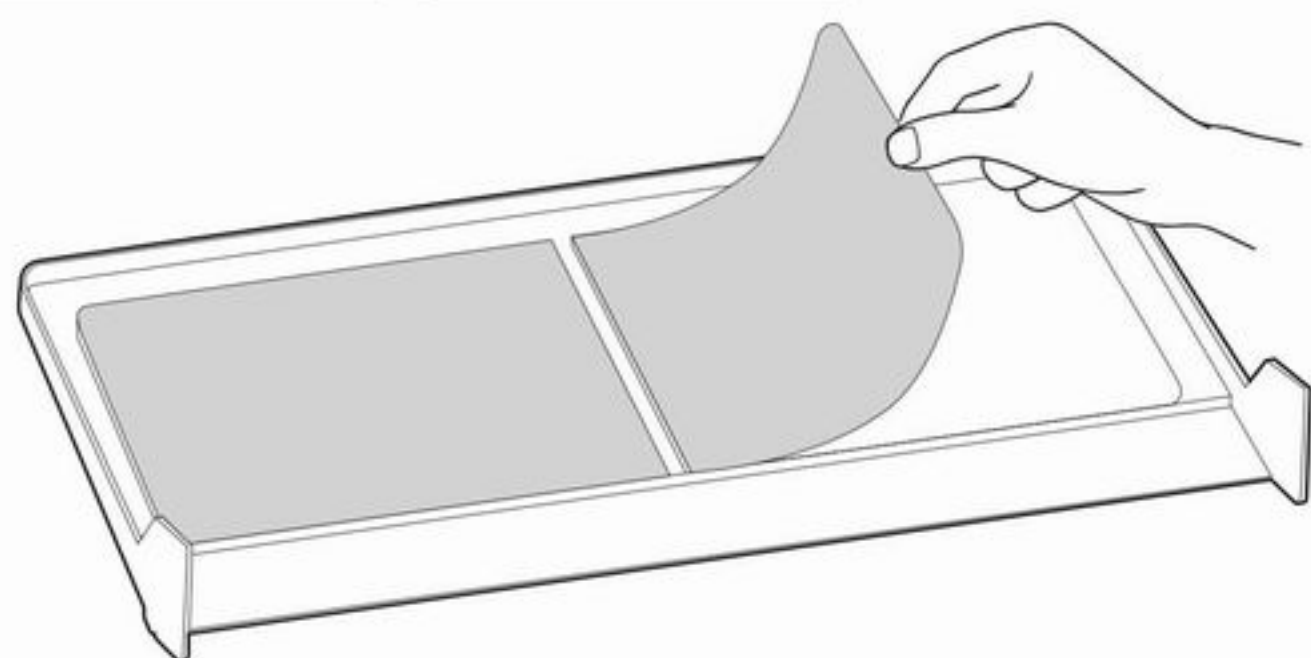

③ Paint spray color from the inside.

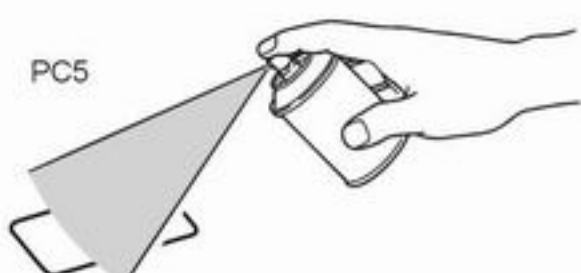
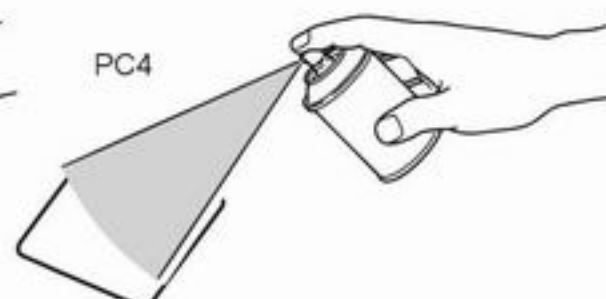
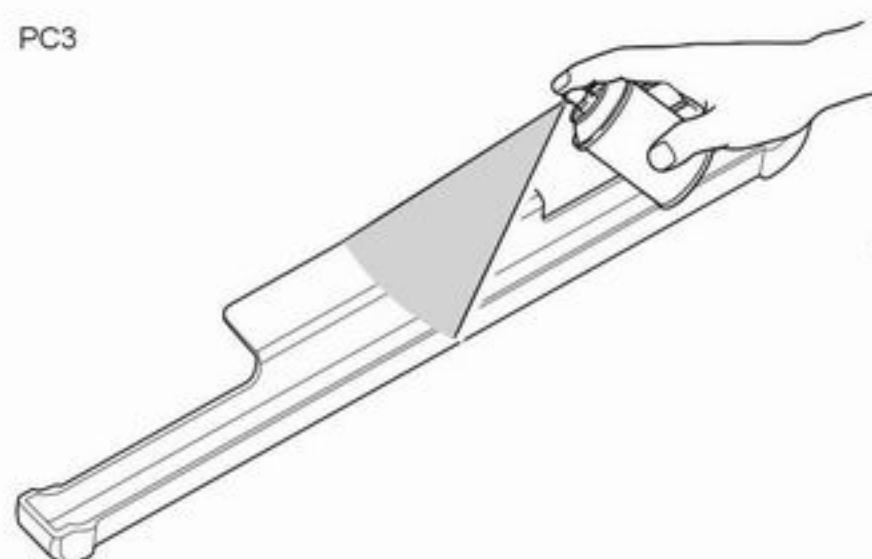
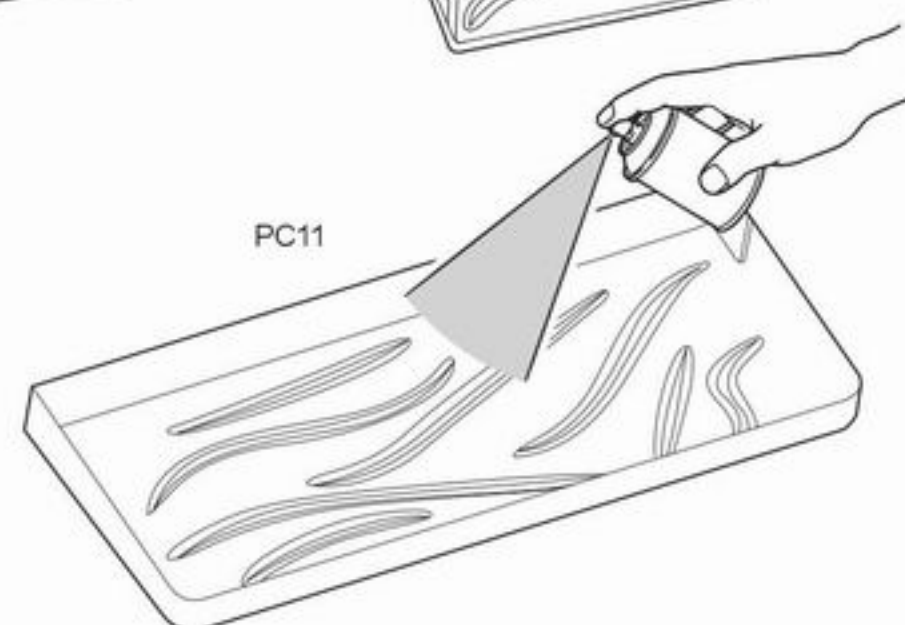
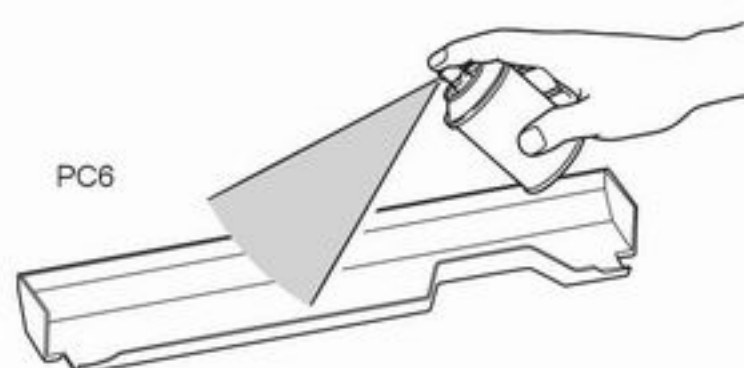
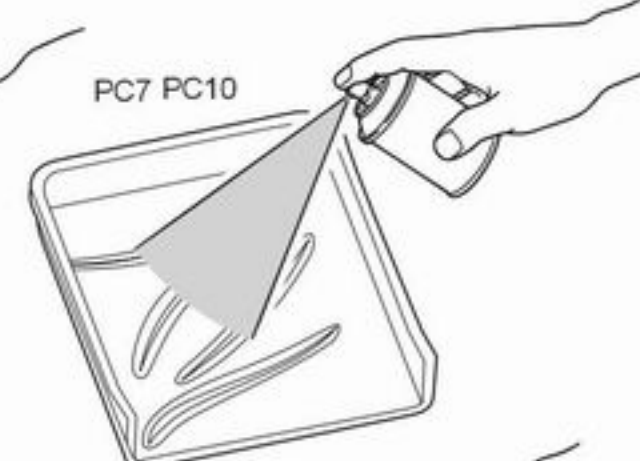
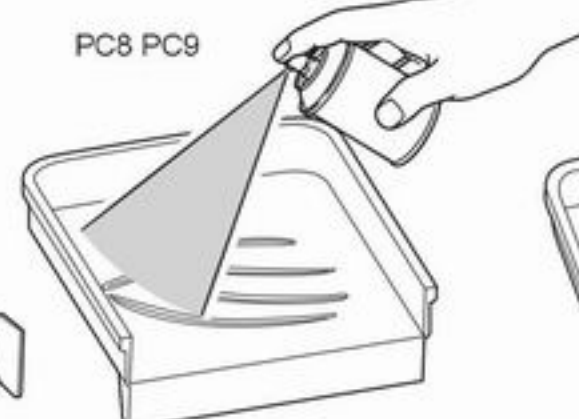
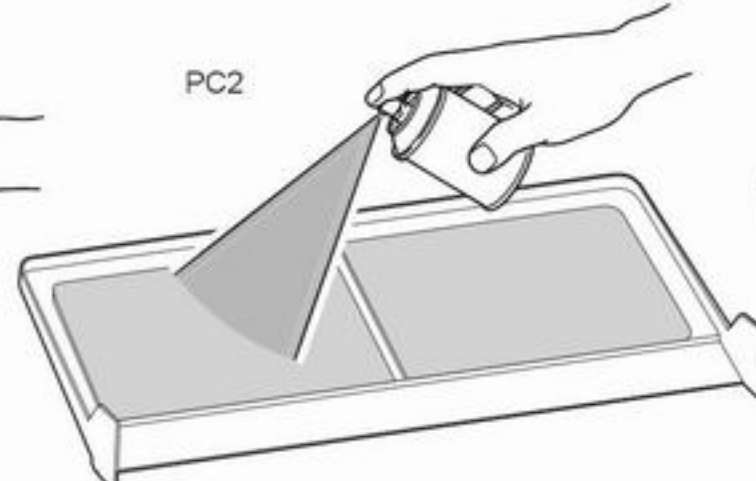
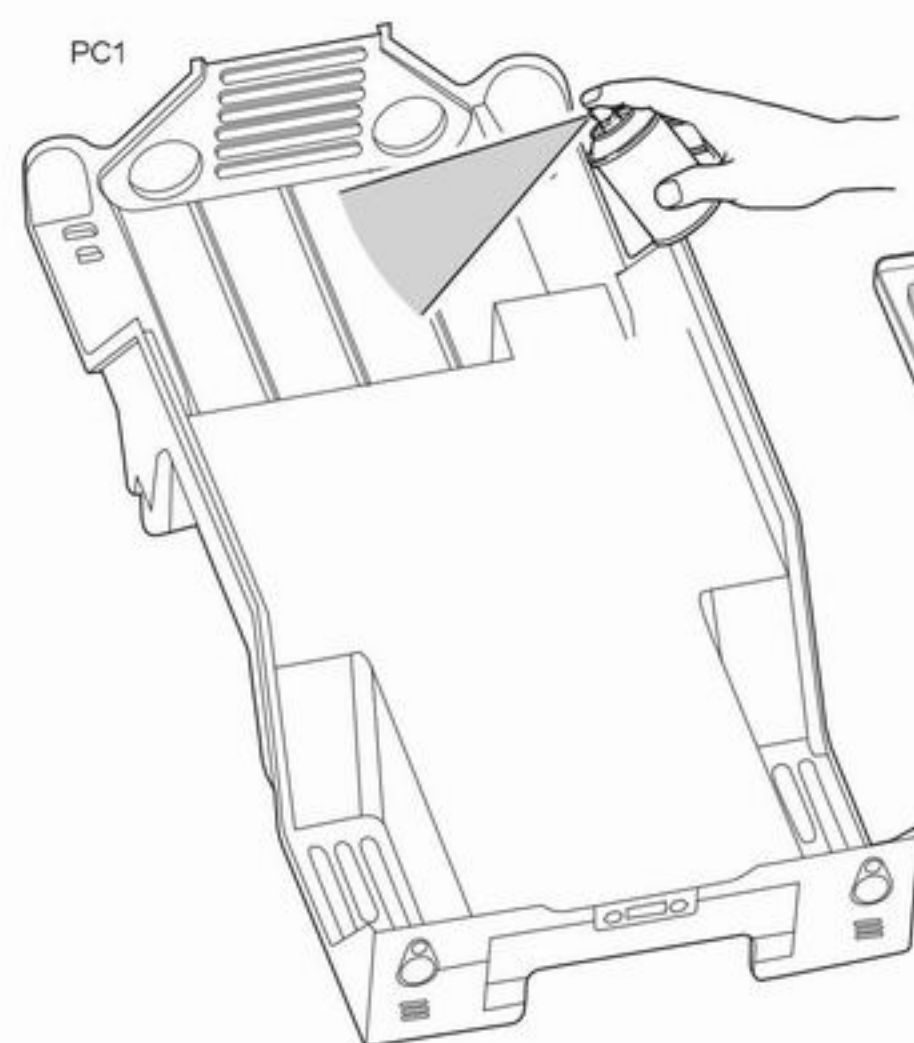

④ After painting, remove the protective film from the body shell.

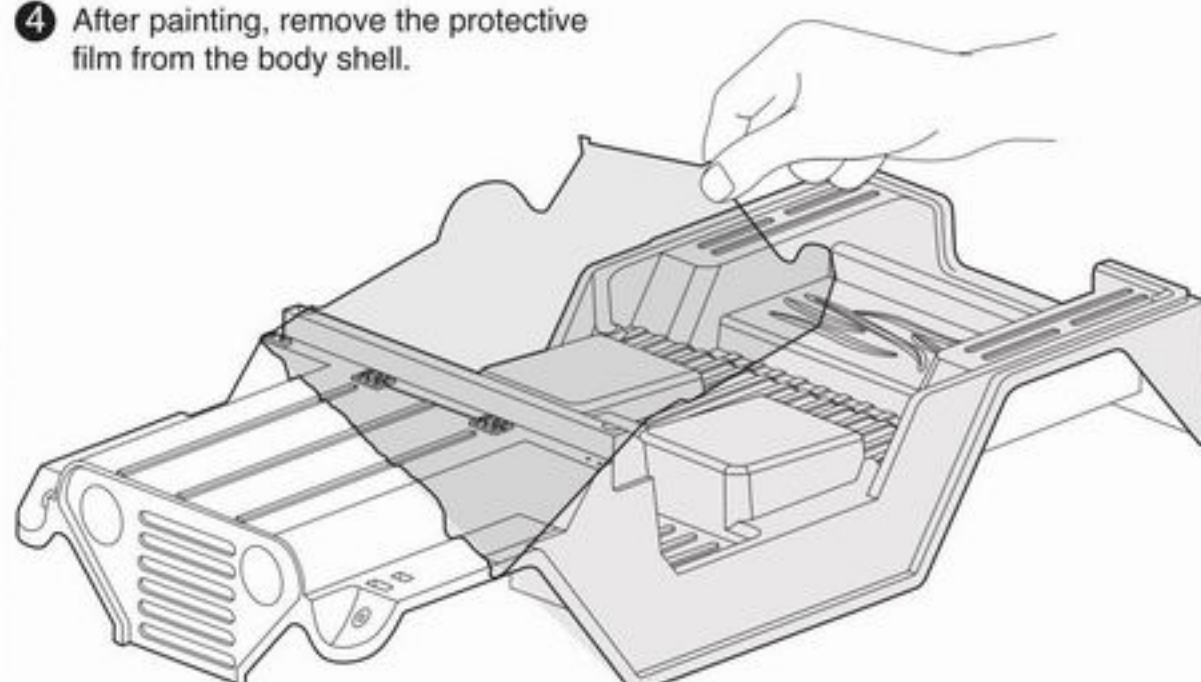

3 Decal

When making the window transparent

Non Decoration Body

When loading LED lights

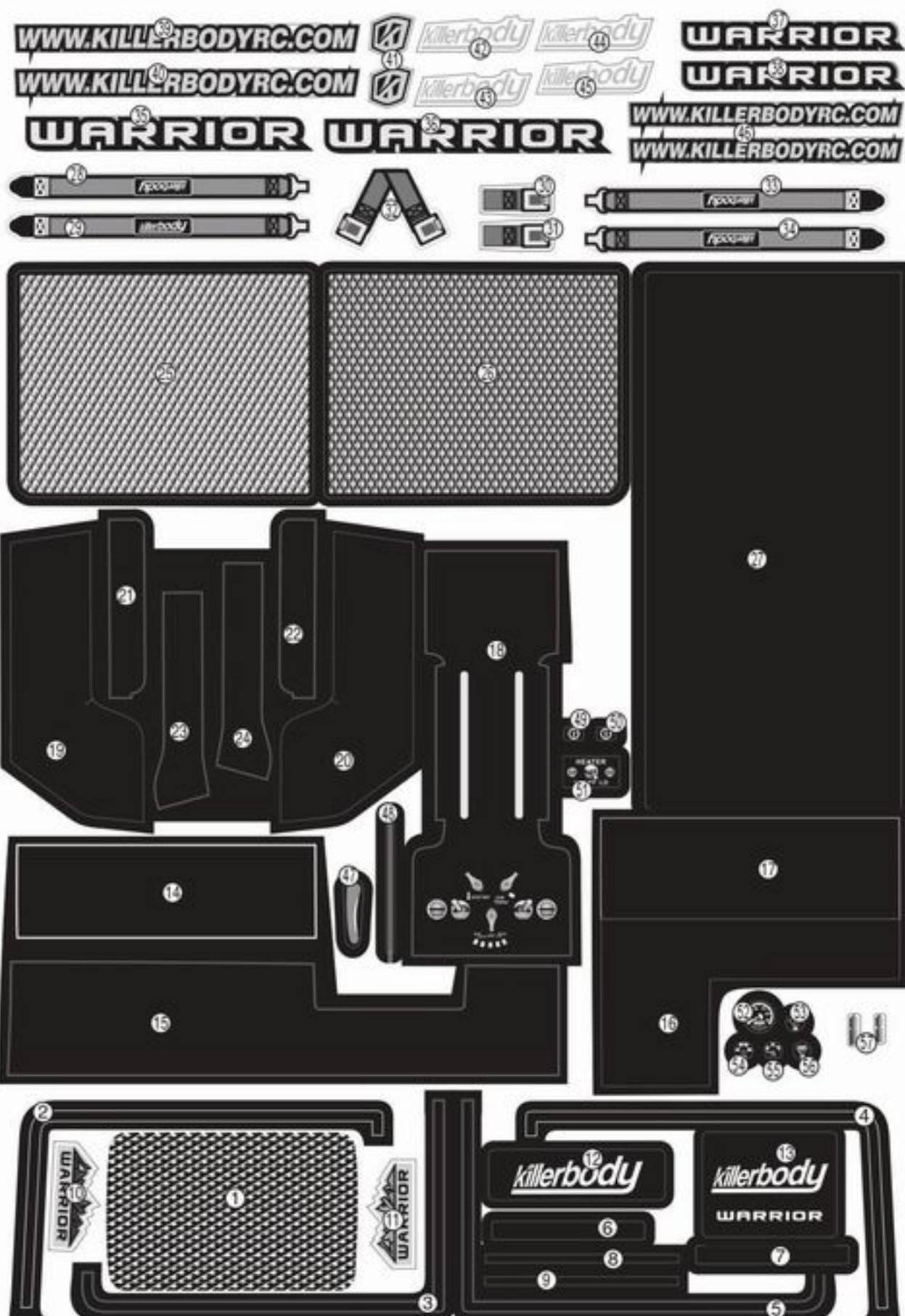

► The decal numbers between brackets are only for the opposite side.

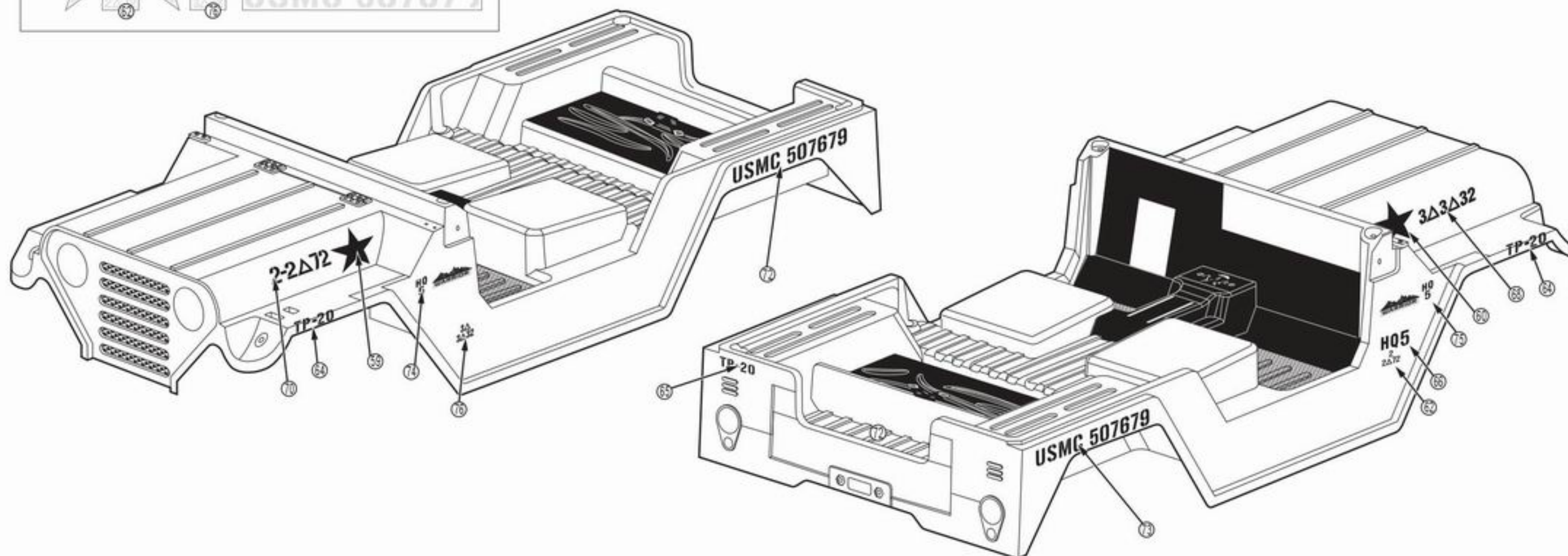
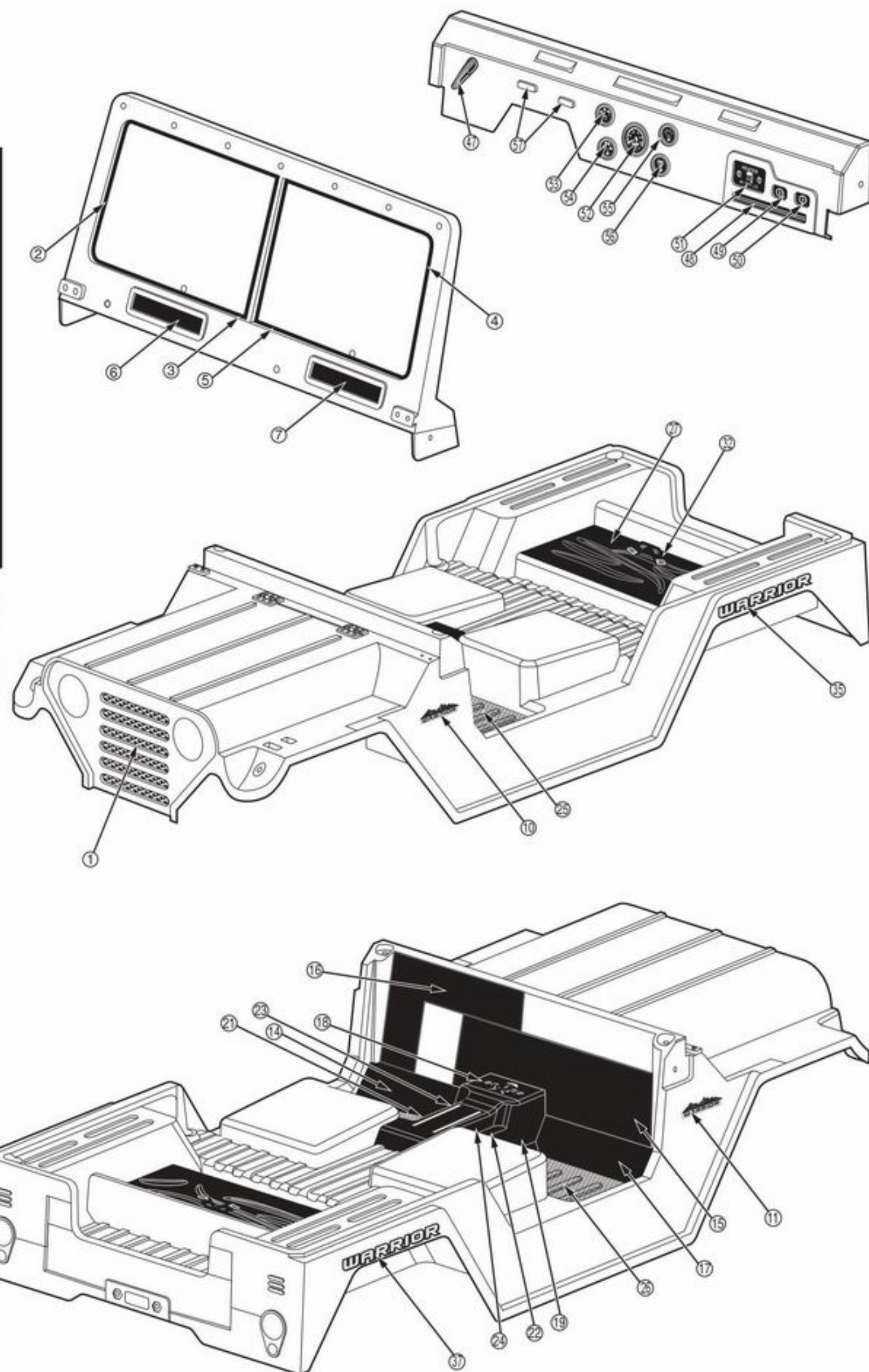

4 Plastic Parts

Decoration Body

When making the window transparent

Non Decoration Body

When loading LED lights

- TAPPING SCREW 2.3X6MM ----- X1
- PLASTIC WASHER ----- X4
- X2

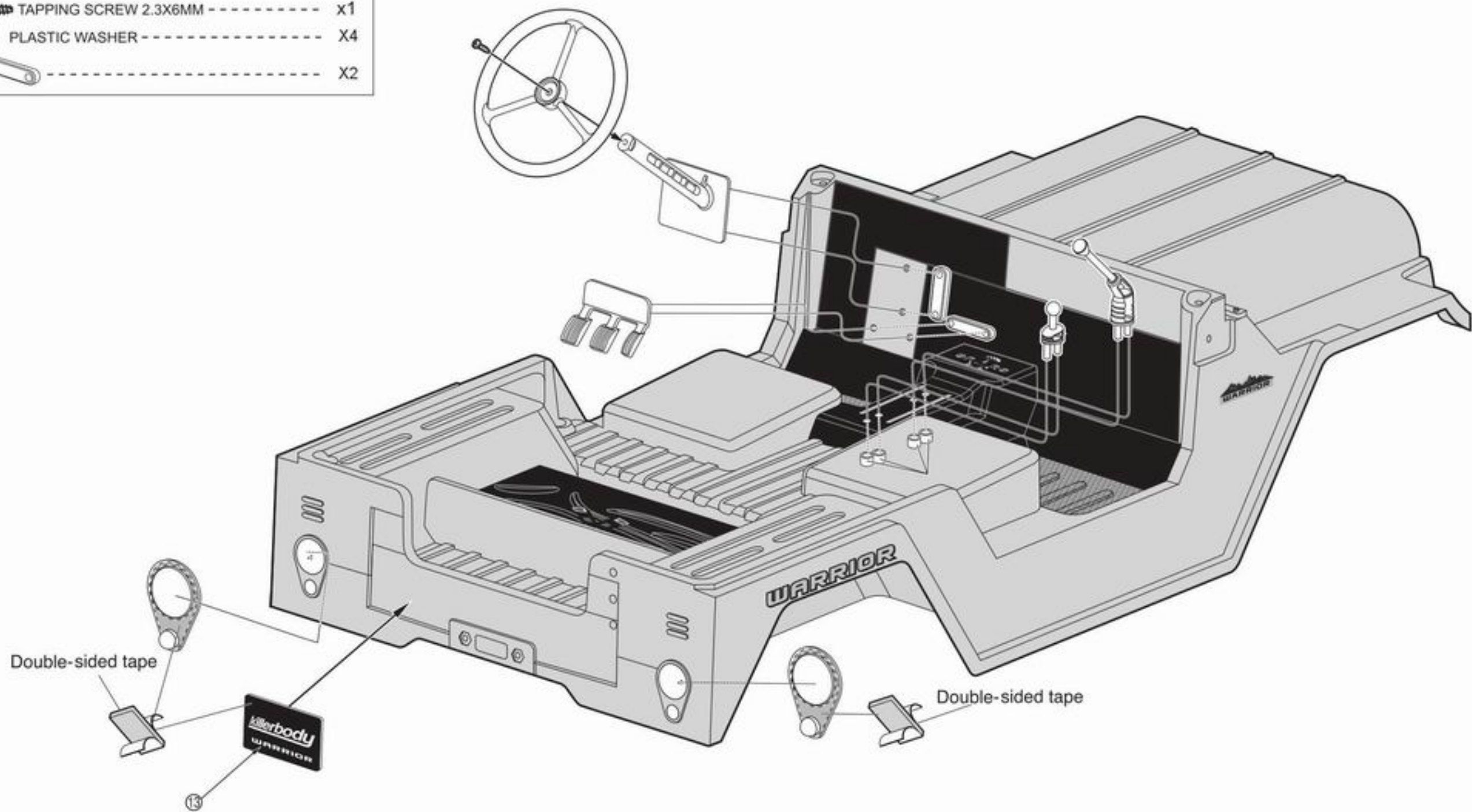

5 Plastic Parts

Decoration Body

When making the window transparent

Non Decoration Body

When loading LED lights

- TAPPING SCREW 2.3X6MM ----- X2
- TAPPING SCREW 2.3X4MM ----- X4
- TAPPING SCREW M1.5X7MM ----- X4
- TAPPING NUT M1.5MM ----- X4
- PLASTIC WASHER ----- X2

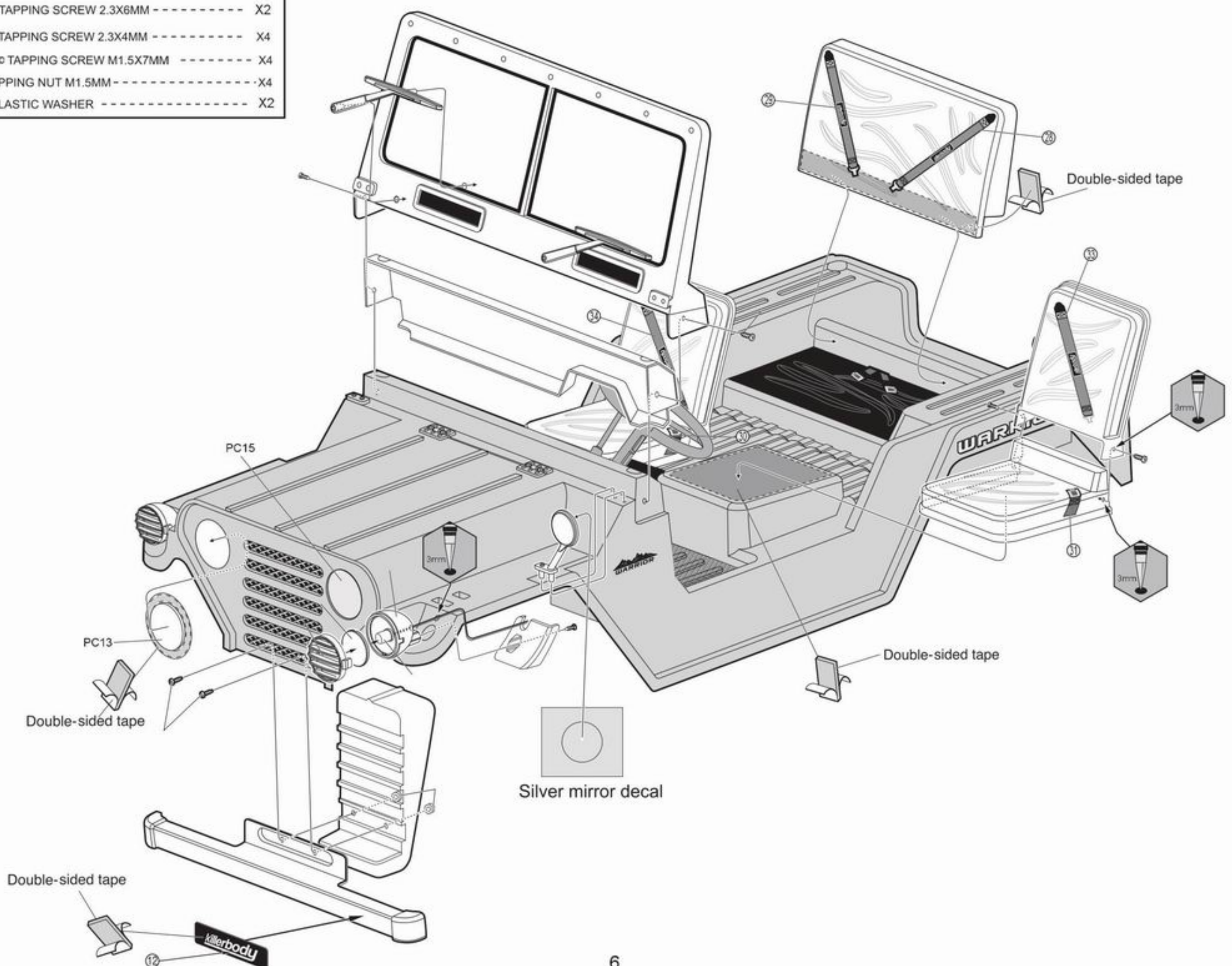



6 Plastic Parts

Decoration Body

When making the window transparent

Non Decoration Body

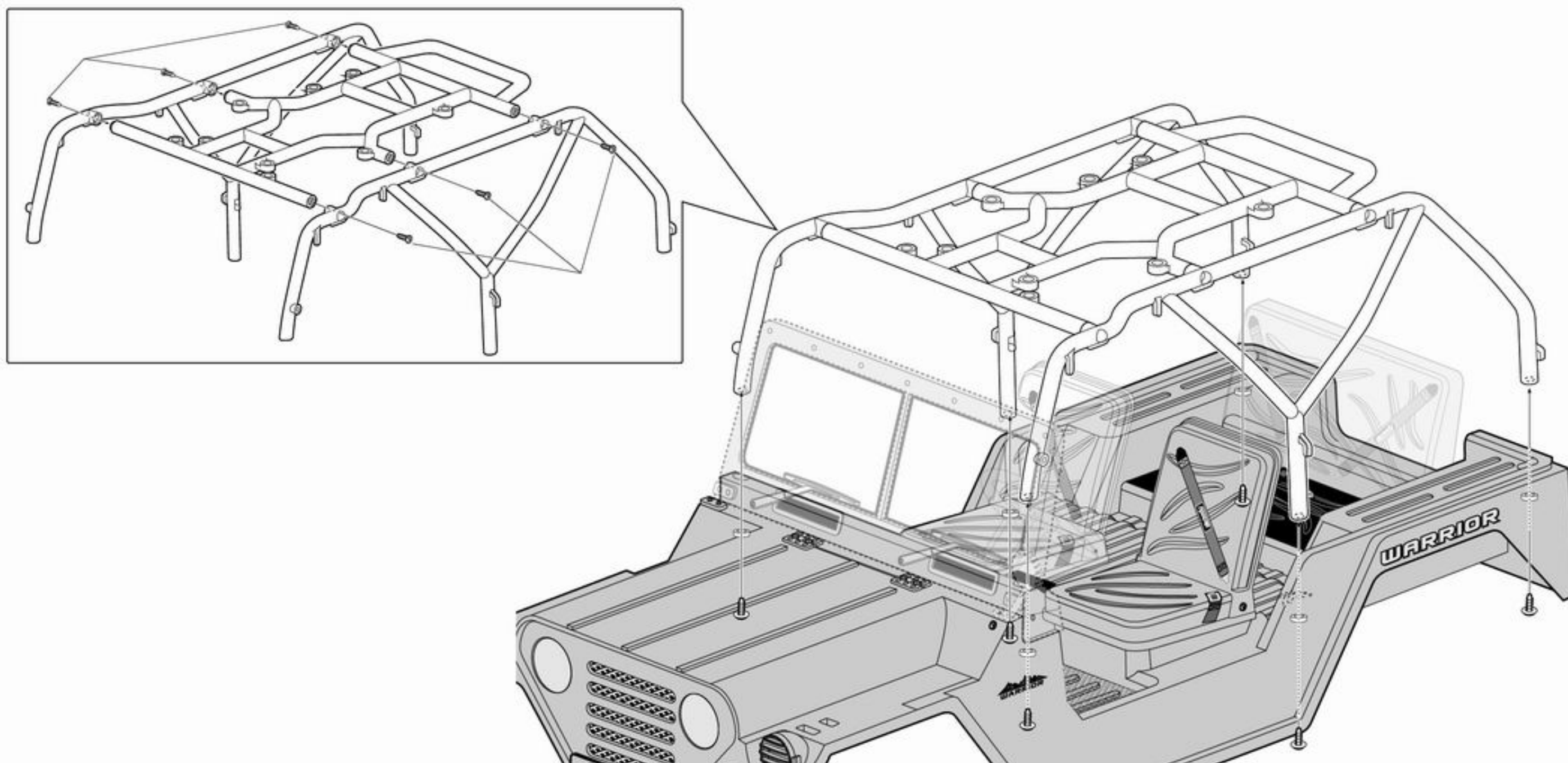

When loading LED lights

-  TAPPING SCREW M3X8MM ----- X12
-  TAPPING SCREW 2.3X6MM ----- X2
-  PLASTIC WASHER ----- X6



7 Plastic Parts

When loading LED lights

-  Please tape the wiring, etc. on the body using the attached aluminum tape.
-  Please put the attached aluminum tape on the top and bottom of the headlights and the taillights.

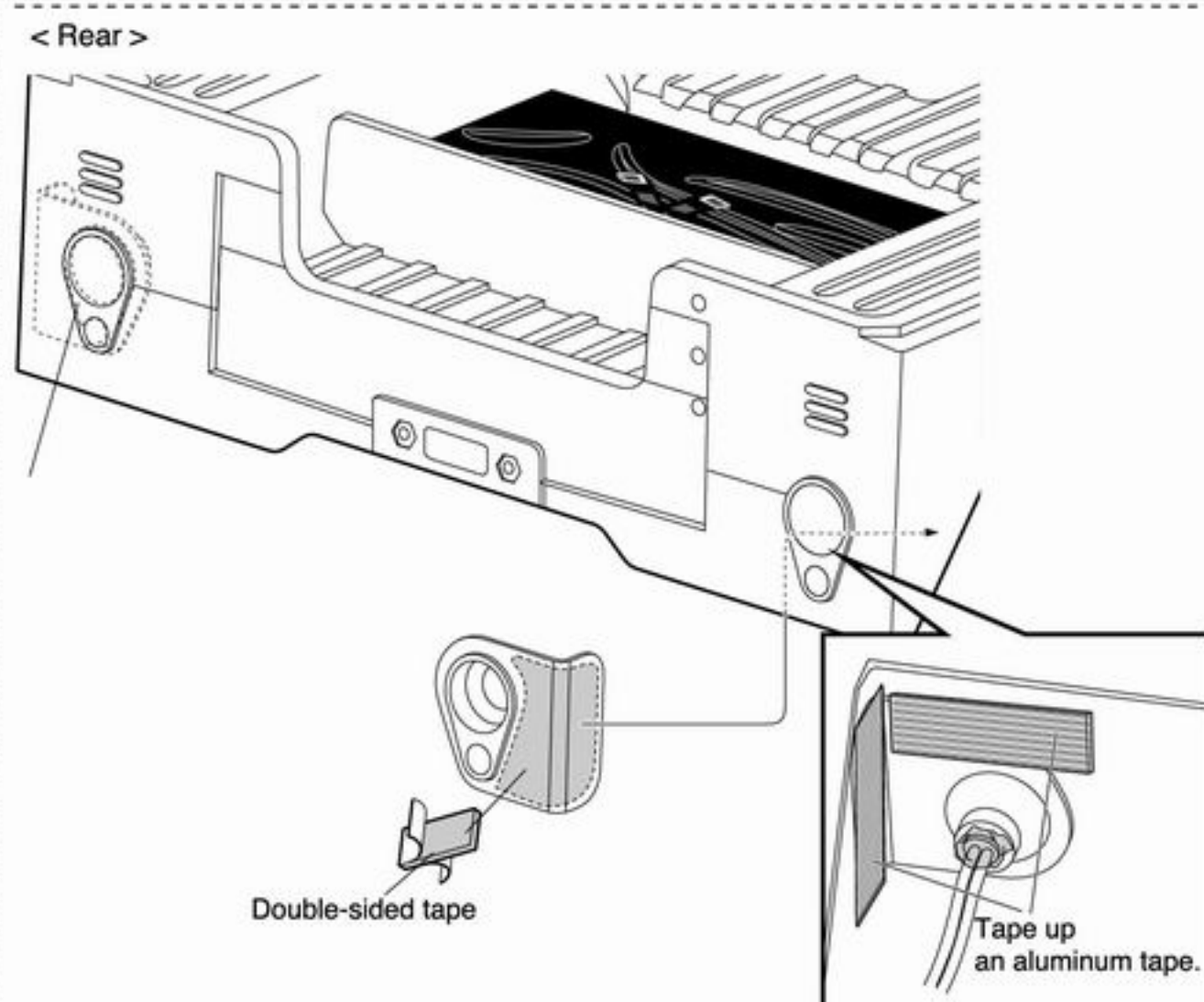
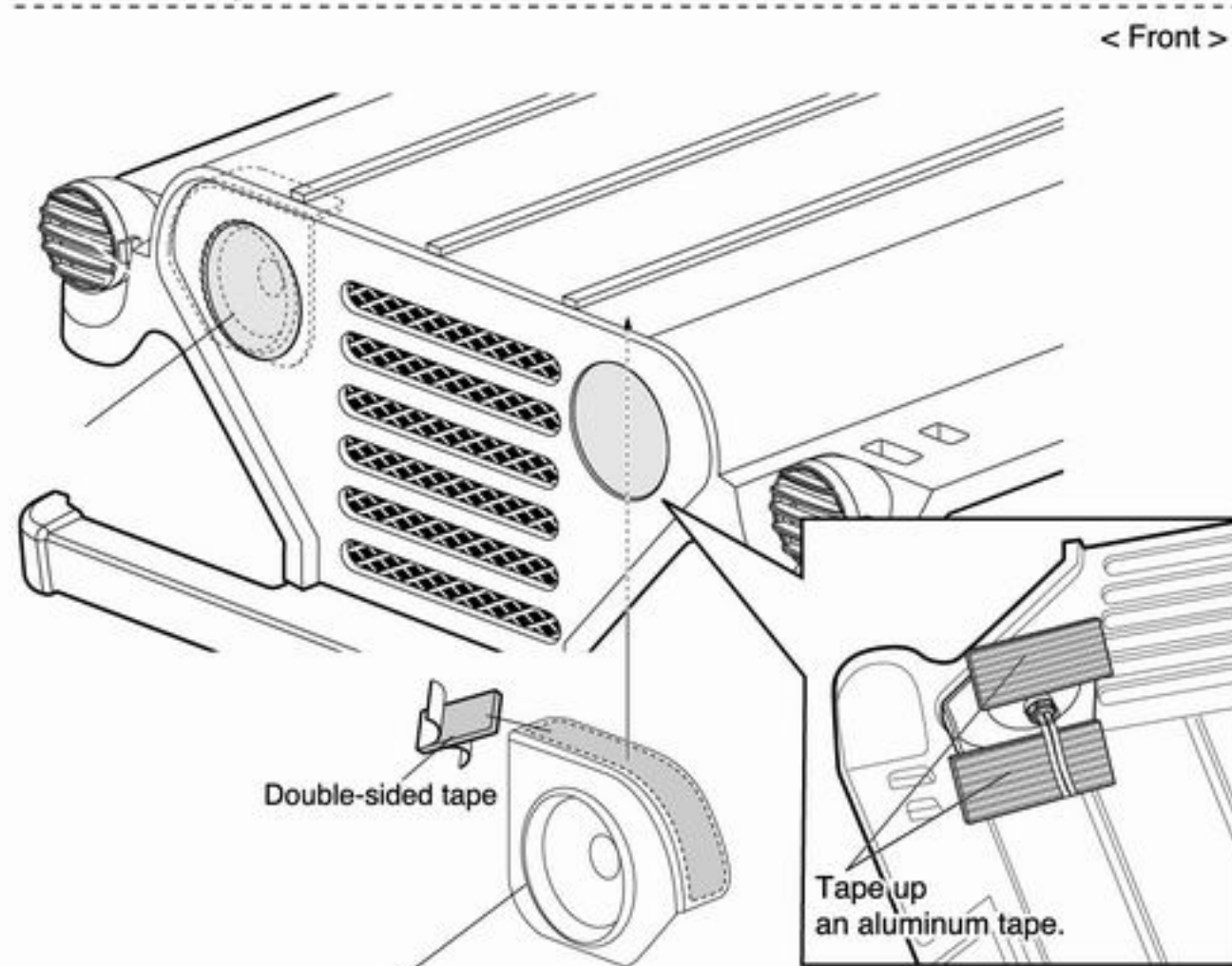
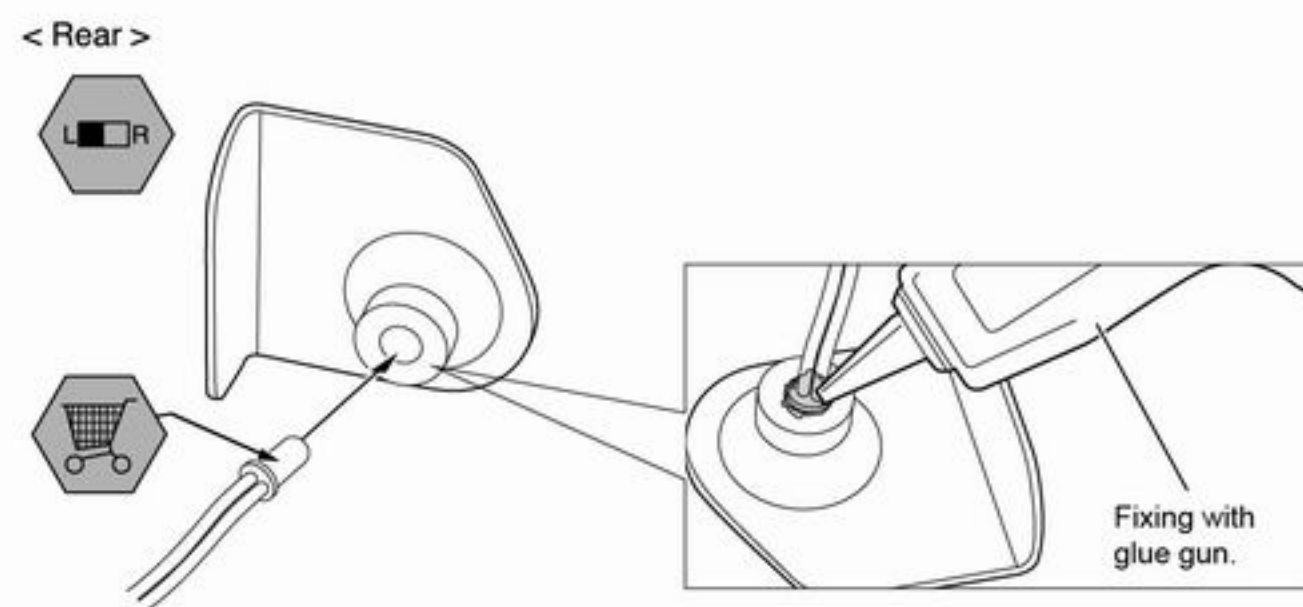
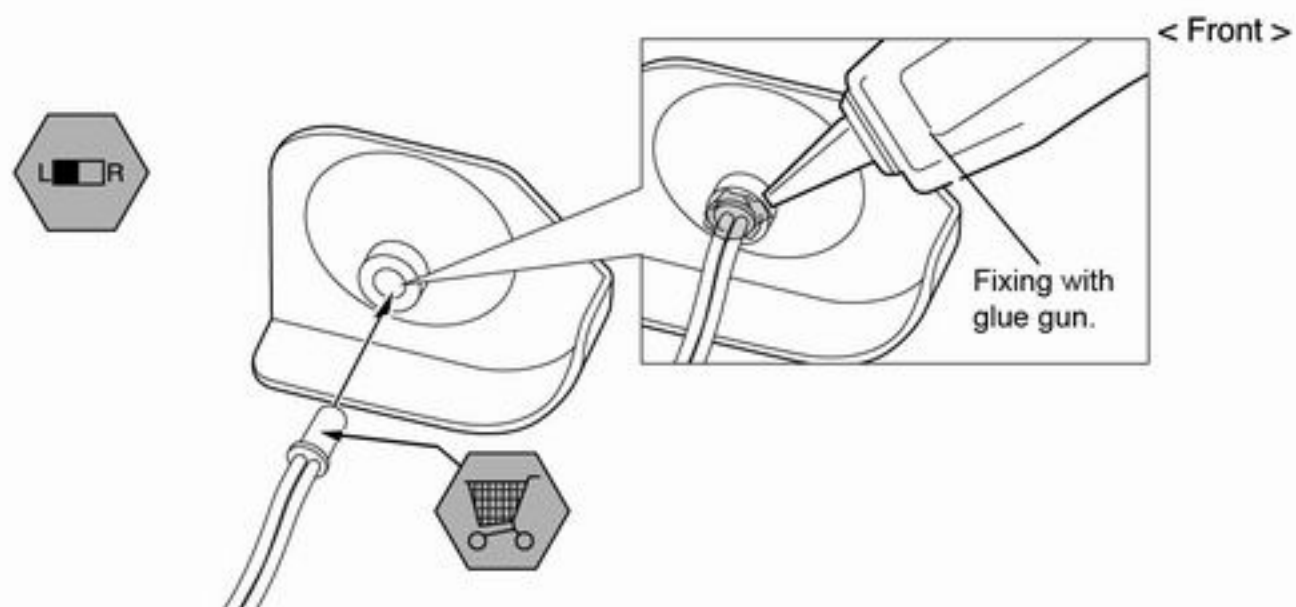

7 Body

Decoration Body

Non Decoration Body

When making the window transparent

When loading LED lights



► For safety reasons, always fit the body shell when running your car.

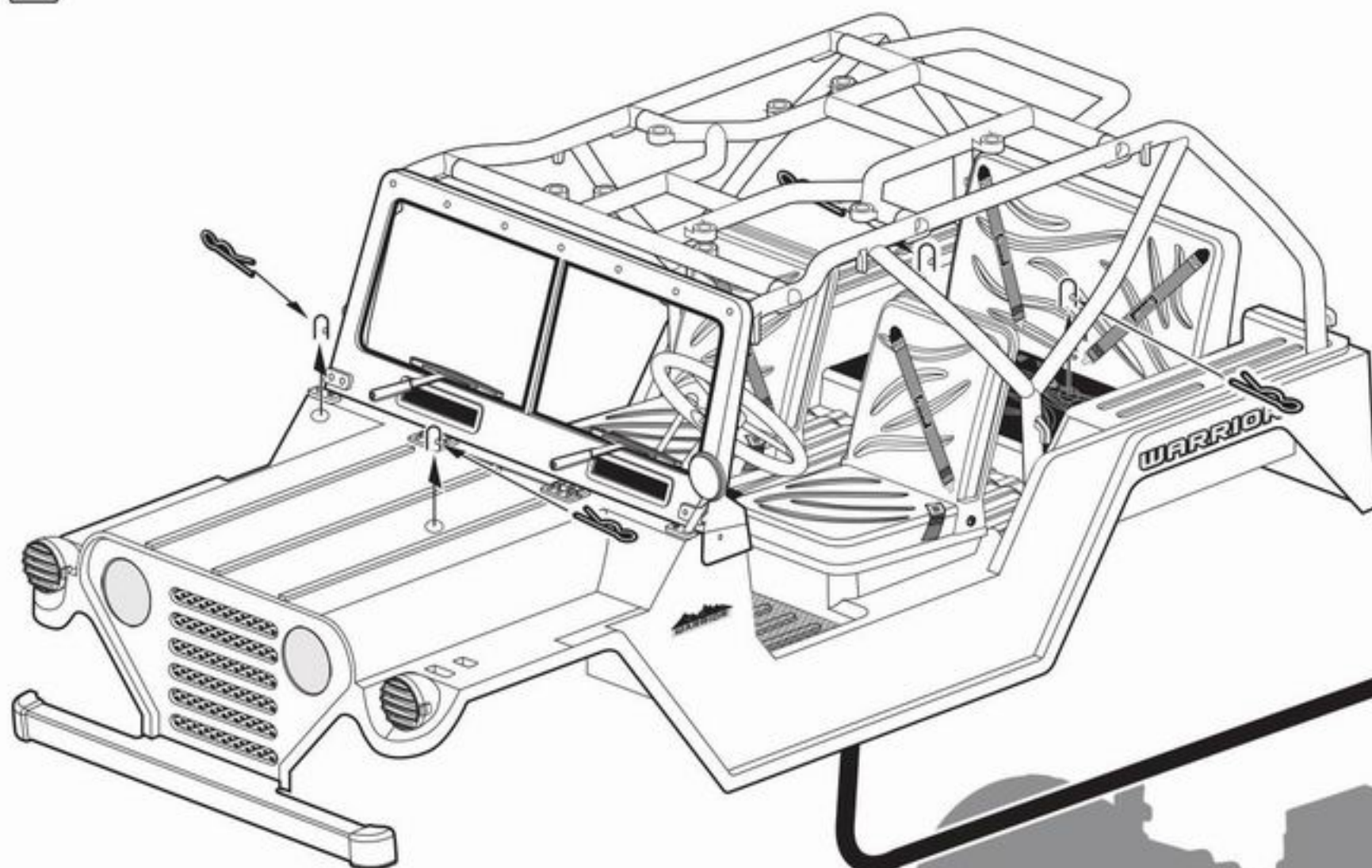

► Use the extension body mount (sold separately) if the body mount height is not enough.

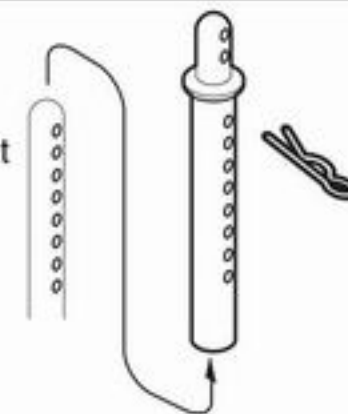

Upgrade Parts

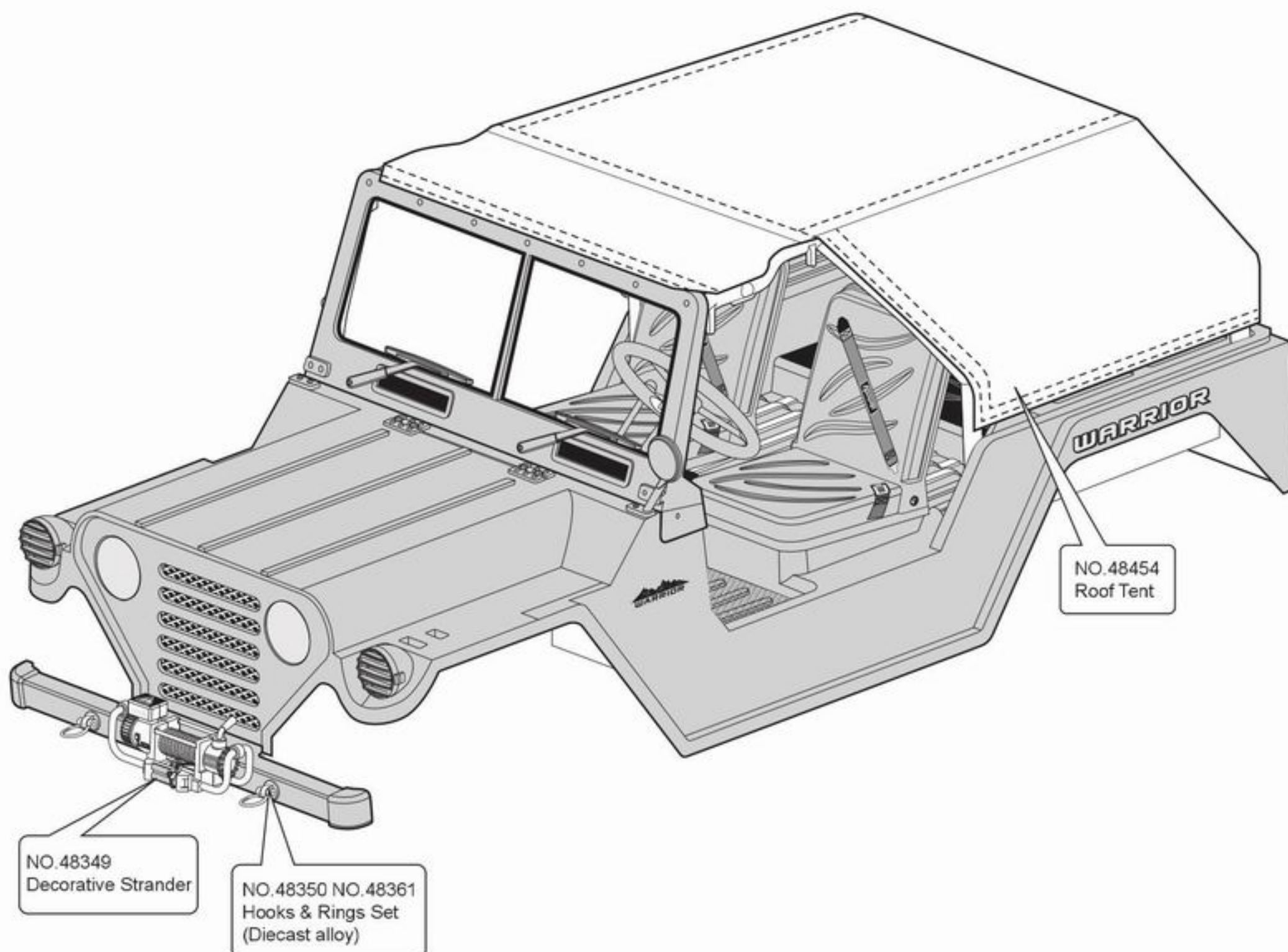

Installation method you can refer to the instruction sheet.

8 Body

Decoration Body

When making the window transparent

Non Decoration Body

When loading LED lights



► For safety reasons, always fit the body shell when running your car.

Fixing with glue

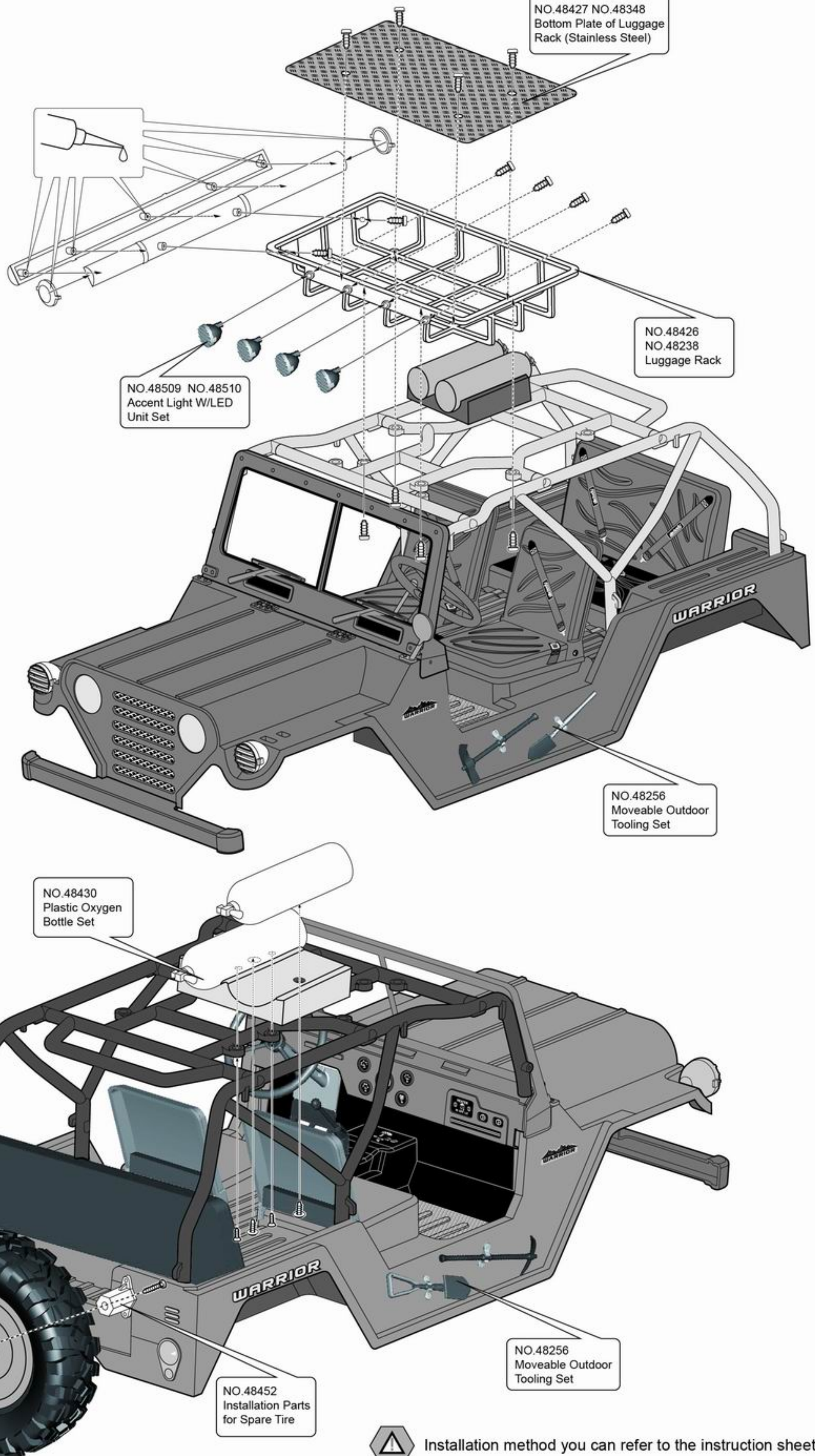
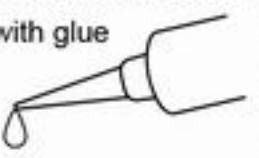

Installation method you can refer to the instruction sheet.

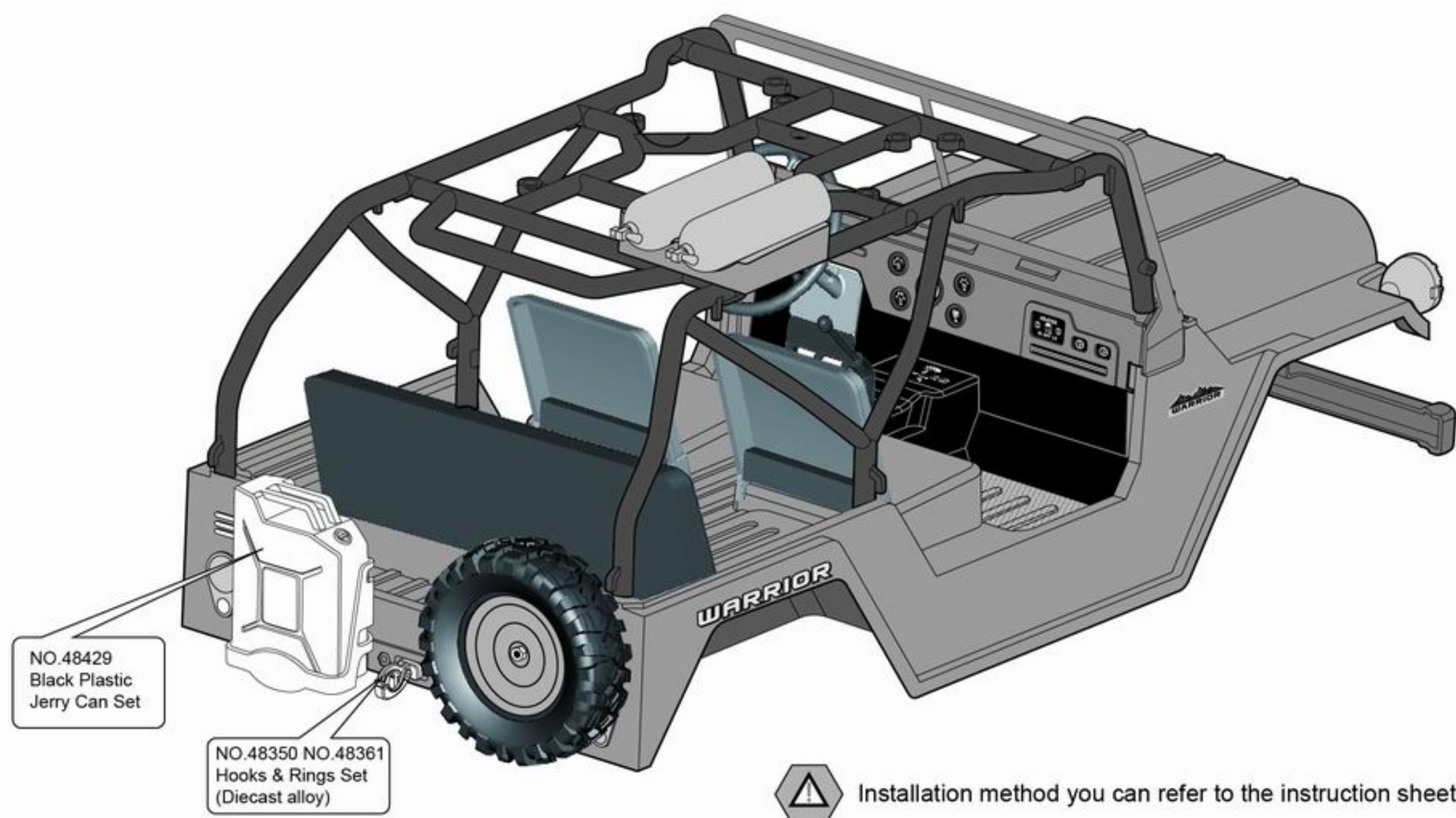

Option Parts & Accessory

No.	Part Names	No.	Part Names
48442	WARRIOR 1/10 Scale Crawler Clear Body	48509	Accent Light W/LED Unit Set 1/10 Truck
48443	WARRIOR 1/10 Scale Crawler Finished Body Silver (Printed) Light buckets assembled	48510	Accent Light W/LED Unit Set 1/10 Truck
48444	WARRIOR 1/10 Scale Crawler Finished Body Red (Printed) Light buckets assembled	48238	Roof Luggage Rack (Double Layer) 1/10 Truck
48445	WARRIOR 1/10 Scale Crawler Finished Body White (Printed) Light buckets assembled	48348	Bottom Plate of Luggage Rack (Stainless Steel) 1/10 Truck
48446	WARRIOR 1/10 Scale Crawler Finished Body Matte Military Green (Printed) Light buckets assembled	48349	Decorative Strander 1/10 Truck
48447	WARRIOR 1/10 Scale Crawler Finished Body Matte Military Desert Color (Printed) Light buckets assembled	48256	Moveable Outdoor Tooling Set 1/10 Truck
48448	Transparent Light Lenses 1/10 Scale Crawler (WARRIOR) Lexan molded / PC material	48270	Stainless Steel Modified Air Intake Mesh
48449	Chromed Light Bucket 1/10 Scale Crawler (WARRIOR) Lexan molded / PC material	48271	Stainless Steel Modified Air Intake Mesh
48450	Black Plastic Parts 1/10 Scale Crawler (WARRIOR)	48272	Stainless Steel Modified Air Intake Mesh
48451	Nylon Anti-roll Bar 1/10 Scale Crawler (WARRIOR)	48434	Plastic Tote Box 1/10 Scale
48453	Plastic Headlight Set 1/10 Scale Crawler (WARRIOR)	48435	Plastic Tote Box 1/10 Scale
48454	Roof Tent 1/10 Scale Crawler (WARRIOR)	48436	Plastic Tote Box 1/10 Scale
48548	Aluminum Alloy Heighten Body Mounts (front) 1/10 Scale Crawler (MARAUDER & WARRIOR)	48437	Plastic Tote Box 1/10 Scale
48452	Installation Parts for Spare Tire 1/10 Truck	48100	LED Light System w/Control Box (8 LEDs) 1/10 Scale
48429	Black Plastic Jerry Can Set 1/10 Truck	48350	Hooks & Rings Set (Diecast alloy) 1/10 Scale
48426	Nylon Luggage Rack & Chimney 1/10 Truck	48361	Hooks & Rings Set (Diecast alloy) 1/10 Scale
48427	Bottom Plate of Luggage Rack (Stainless Steel) 1/10 Truck	48523	Metal Euphroe 1/10 Scale
48430	Plastic Oxygen Bottle Set 1/10 Truck	48544	Metal Euphroe 1/10 Scale
48431	Luggage Net 1/10 Truck	48522	Toolbox w/Tool Set 1/10 Scale
48432	Luggage Net 1/10 Truck		
48433	Camouflage Net 1/10 Truck		
48514	Cloth Cable Ties 1/10 Truck		
48515	Cloth Cable Ties 1/10 Truck		
48438	Chromed Plastic Tote Box Finished Type 1/10 Truck		
48439	Chromed Plastic Tote Box Finished Type 1/10 Truck		
48440	Chromed Plastic Tote Box Finished Type 1/10 Truck		
48441	Chromed Plastic Tote Box Finished Type 1/10 Truck		