

● Symbols used throughout the instruction manual, comprise:



Cut off shaded portion.



5mm  
Drill holes with  
the specified diameter.



Pay close attention here!



Must be purchased  
separately.



Assemble left and right sides  
the same way.

### PARTS

TAPPING SCREW ----- X6

CONNECTING WIRE X1

TRANSPARENT NUMBER PLATE

PC1 PC1 PC1

SMD LED LIGHT X1

ELECTROPLATED PARTS

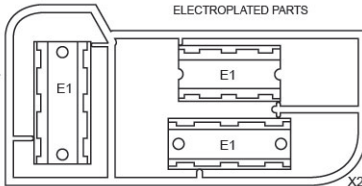

PLASTIC PARTS

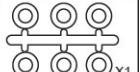

OVERSPRAY FILM



1. Remove the blue protective film from the transparent number plate.
2. Stick on the number and letter that you need.
3. Paint the side that with number and letter using spray color.
4. Remove the overspray film and the protective film on the backside.

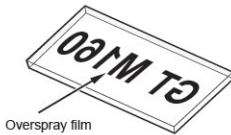
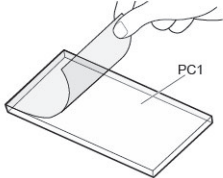

5. Assemble the SMD LED Light
6. Insert the transparent Number plate into the chromed Number plate frame.
7. Rear Number Plate.

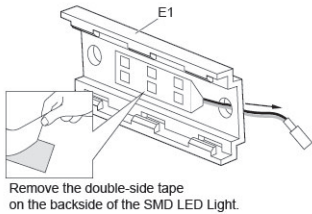

Remove the double-side tape on the backside of the SMD LED Light.

