

Date 06.09.2009
Driver Stefan Scheuenpflug
Track MSC Osterhofen e.V.

Air cond. Hot, Dry
Track cond. Bumpy
Track spec. Med. Traction

Diff. Oil
 Front Grease 5000
 Center Grease 5000
 Rear Grease 1000

Clutch bell
 13T 14T 15T
Spur gear
 40T other _____

Engine Novarossi Toro Nero **Plug** C6TGC
Muffler 41021 **Shim** _____
Exhaust 9901 **Run Time** _____
Fuel Byron Gen.2 25% 8:33 min

Front Shock Setup
 Oil 450
 Spring Darkgrey
 Piston 4x1,5 mm
 Length _____
 Preload _____

Rear Shock Setup
 Oil 400
 Spring Darkgrey
 Piston 4x1,3 mm
 Length _____
 Preload _____

Clutch Setup
 Type PSM Prototype
 Shoes 3x Carbon
 Spring 1.0mm
Wheelbase
 short medium long

Tires
 Front _____
 Rear _____
 Foam _____

Front Suspension

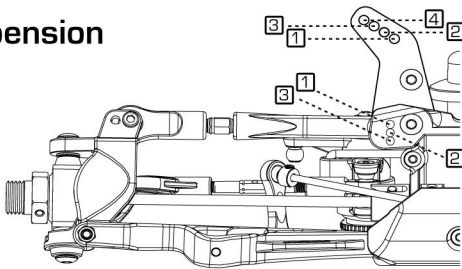

Outer Upper Arm Location

Inner Outer

Upper Shock Location

1 2 3 4

Inner Upper Arm Location

1 2 3 (3 only on PSM shock tower)

Rebound Stop 106,00 mm

(shock upper location to shock lower location)

Ackermann Location

In Mid. Out

Camber

2 ° (- In / + out)

Toe angle

+ 3 ° (- In / + out)

Ride Height _____

Swaybar 2,4 mm

Rear Suspension

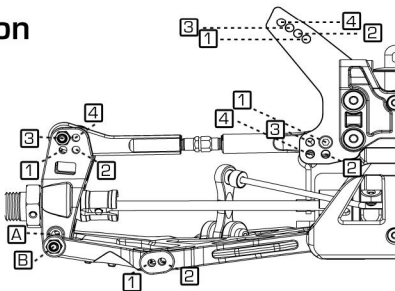

Outer Upper Arm Location

1 2 3 4

Upper Shock Location

1 2 3 4

Inner Upper Link Location

1 2 3 4 5 6

Rebound Stop 122,00 mm

(shock upper location to shock lower location)

Toe In

2 2,5 3

Lower Shock Location

1 2

Hub Location

A B

Camber

1,5 ° (- In / + out)

Ride Height _____

Swaybar 2,3 mm

Anti Squat

2 2,5 3

Notes

Hobao Parts: New 4mm Chassis, Aluminium Top-Plate, New front lower arms, Aluminium Front/Rear Chassis Braces, Spider Diffs,

PSM Parts: Vertical engine mounts, ventilate brake discs, Aluminium cvd axles, Aluminium suspension and NoPop balls, Carbon shock towers,

V2 Wheel Nuts, Rear +2mm Front -1mm V2 Wheel Hubs