

PROLINE

PRODUCT NEWSLETTER OCTOBER 2016

HOLE SHOT



TUNDRA
TRD PRO

TRUE SCALE
SHORT COURSE CLEAR BODY
#3476-00

Inside:

**ULTIMATE
PERFORMANCE**

Back:

**NEW PRODUCT
RELEASES**

Connect With Us



facebook.com/prolinerracing



twitter.com/prolinerracing



youtube.com/prolinevideo



instagram.com/prolinerracing



prolinerracing.com/blog



Bomber shown with Pro-Line 2" & 4" Super-Bright LED Bars,
BFGoodrich® KO2 2.2" Tires Mounted on 6 Lug FaultLine Wheels.

THE ULTIMATE SCALE PERFORMANCE

ULTRA RESERVOIR SHOCKS [105mm]
for Rock Racers & Crawlers Front or Rear
#6288-00

The new Ultra Reservoir Shocks feature a fully functioning reservoir with a realistic divider piston and set screw for adjusting the shock rebound.

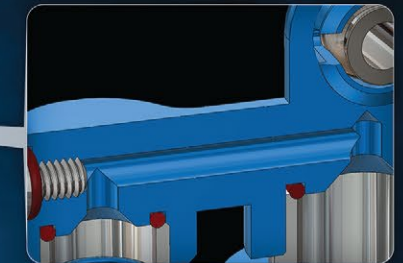
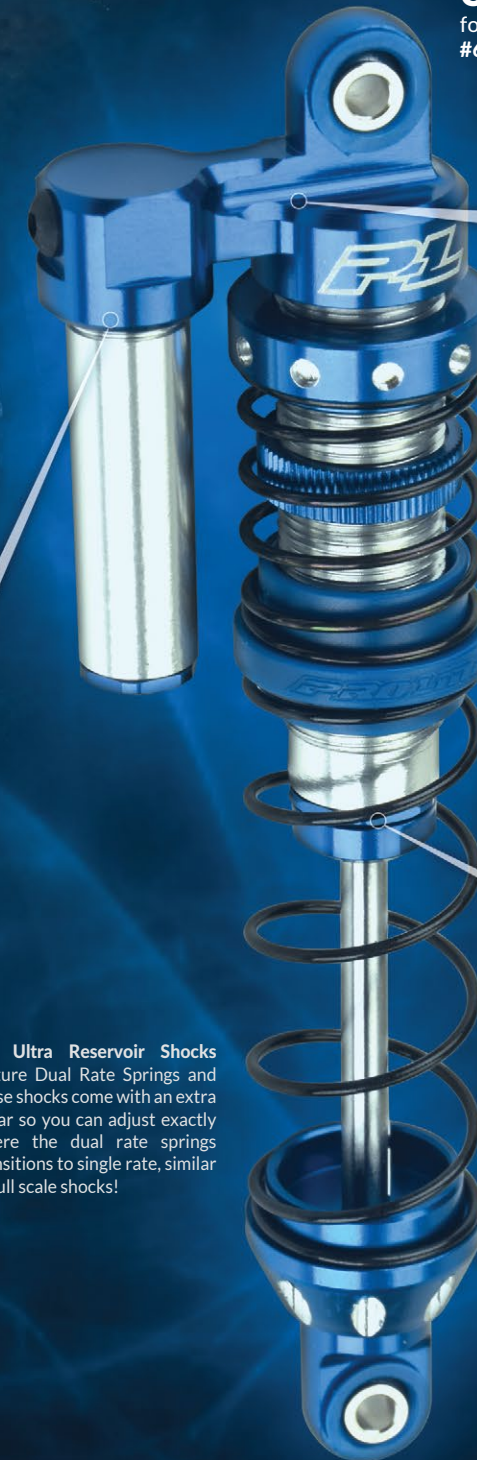
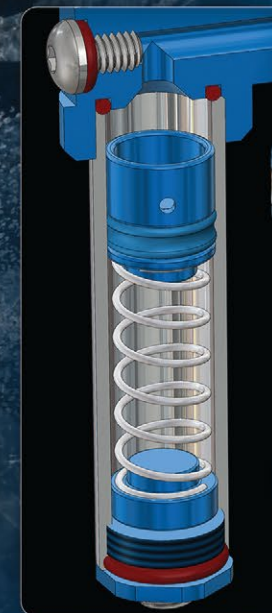

The Aluminum Shock Cap, Shock Body, Reservoir, Bottom Caps, Spring Perch, Shock End and Steel Shock Shaft have all been CNC machined to exacting tolerances to achieve the highest quality shock imaginable and have been designed with Scale Realism in mind.

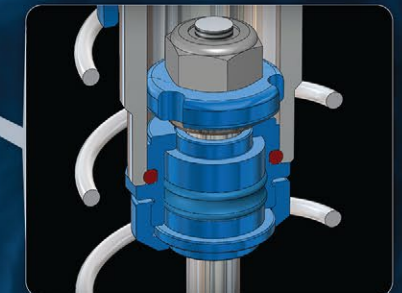

X-Ring seals are used for both the main shaft seal and the divider piston for the smoothest and lowest friction seal possible for these 9mm Bore Shocks.

The Ultra Reservoir Shocks feature Dual Rate Springs and these shocks come with an extra collar so you can adjust exactly where the dual rate springs transitions to single rate, similar to full scale shocks!



ALL-TERRAIN T/A KO2 G8 •
2.2" Crawler Tire
#10122-14 2.2" (5.43"H x 1.80"W)



BAJA T/A KR2 G8 •
2.2" Crawler Tire
#10119-14 2.2" (5.65"H x 2.0"W)

FLAT IRON XL G8 •
2.2" Crawler Tire
#10115-14 (5.50"H x 2.28"W)

FLAT IRON M3 •
2.2" Crawler Tire
#1146-12 (4.84"H x 2.15"W)



SUPER SWAMPER XL G8 •
2.2" Crawler Tire
#10107-10 Mounted/ Black FaultLine
#10107-14 (5.80"H x 2.28"W)

SUPER SWAMPER G8 •
2.2" Crawler Tire
#1166-14 (5.40"H x 2.05"W)

Please note: All tires and wheels are sold in pairs, unless otherwise noted.
BFGoodrich® Tires Trademarks are used under license from Michelin. INTERCO® Super Swamper trademarks used under license to Pro-Line.

PRO-LINE®



PROLINERACING.com



PL

NEW RELEASES



SHORT COURSE

Toyota® Tundra TRD Pro True Scale Clear Body
for PRO-2 SC, Slash®, Slash® 4X4, SC10 (Requires Pro-Line Extended Body Mount Kit, Sold Separately)
#3476-00



1:10 BUGGY

Positron 2.2" Off-Road Rear Tires

for 1:10 Buggy Rear
#8256-03 M4 (Super Soft) •
#8256-17 MC (Clay) •



1:8 BUGGY

ElectroShot Off-Road Tires

for 1:8 Buggy Front or Rear
#9059-002 X2 (Medium) ••
#9059-003 X3 (Soft) •••
#9059-02 M3 (Soft) ••
#9059-03 M4 (Super Soft) •••



SCALE CRAWLER

Ultra Reservoir Shocks (105mm)
for Rock Racers and Crawlers, Front or Rear
#6288-00

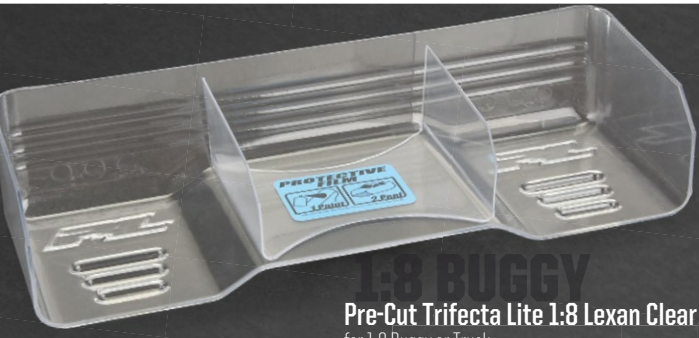

Pre-Cut Trifecta Lite 1:8 Lexan Clear Wing
for 1:8 Buggy or Truck
#6291-17

AMBUSH 4X4

Replacement Parts

- for Pro-Line 1:25 Ambush 4x4 Mini Crawler
- #4004-01 Li-Ion Battery
 - #4004-02 USB Charger
 - #4004-04 Frame Set
 - #4004-05 Micro Torque Motor
 - #4004-06 G9000 Servo
 - #4004-07 Transmission
 - #4004-08 Shocks/Driveshaft
 - #4004-09 Leaf Spring Set
 - #4004-10 Axle Set
 - #4004-11 Flat Iron Tire and Denali Wheel Set
 - #4004-12 Pre-Painted Body Kit

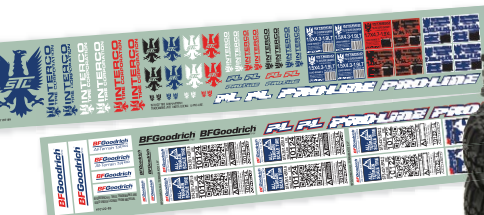
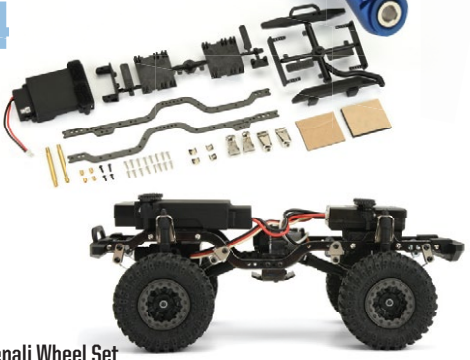

SCALE CRAWLER

Scale Tire Decals
for BFGoodrich® and Interco® Tires

- #1197-33 Interco TSL SX Super Swamper (1163, 1197 & 10107)
- #10119-33 BFGoodrich® Baja T/A KR2 (10118-14 and 10119-14)
- #10122-33 BFGoodrich® All-Terrain K02 (10122-14 and 10124-14)



NOW AVAILABLE FOR SHORT WHEELBASE



Chevrolet® Corvette™ C7.R (GT1)

Clear Body for 1:8 GT (Short Wheelbase)
#1551-40

PROTOform
RACE BODIES

Please note: All tires and wheels are sold in pairs, unless otherwise noted. All bodies are sold in crystal clear lexan and are painted for advertising purposes only. Slash® is a registered trademark of Traxxas®. L.P. General Motors® trademarks used under license to Pro-Line. Toyota® trademarks used under license to Pro-Line. BFGoodrich® Tires Trademarks are used under license from Michelin. INTERCO® Super Swamper trademarks used under license to Pro-Line.

PRO-LINE

prolineracing.com



CML Distribution +44 (0)1527 575349

Saxon House, Saxon Business Park, Hanbury Road, Bromsgrove, Worcestershire B60 4AD
tel: +44 (0)1527 575349 fax: +44 (0)1527 570536 www.cmldistribution.co.uk